



# 400 Series Databook

somfy®

# Table of Contents

<b>Introduction</b>	4
<b>Motor Specifications</b>	
Sonesse® 40 AC Zigbee	8
Sonesse® 40 PoE	9
Sonesse® 40 RS485	10
Sonesse® 40 WT	11
Sonesse® 40 RTS	12
LS 40 WT	13
Altus® 40 RTS	14
<b>Controls</b>	
Zigbee® Technology	15
Power over Ethernet (PoE)	15
Somfy Digital Network™ (SDN) RS485	16
Radio Technology Somfy® (RTS)	18
Wired Technology	20
Dry Contact	21
<b>40mm Hardware Systems</b>	
Acmeda®	22
Somfy Decorator Type	23
RollEase® Skyline	26
Somfy CTS 40	27
Bracket, Fascia, and Cassette Solutions - RollEase®	28
<b>40mm Mechanical Accessories</b>	29

Acmeda® is a registered trademark of Acmeda International Group Incorporated  
RollEase® is a registered trademark of RollEase® Inc. - Stamford, CT.  
Crestron® is a registered trademark of Crestron Electronics, Inc.  
ZMC® is a registered trademark of ZMC® Window Coverings  
Universal Remote Control, Inc. is a trademark of Universal Remote Control, Inc.  
Zigbee® is a registered trademark of Connectivity Standards Alliance.  
Amazon, Alexa, and all related logos are the trademarks of Amazon.com, Inc. or its affiliates.  
All brands, products, and trademarks are the property of their respective owners.

# Pro Tools and Support



**The TaHoma® pro app** provides hassle-free manufacturing and installation. A revolution in building and programming smart window coverings.



**Serv-e-Go®** is a web application for dealers to elevate after-sales support by remotely diagnosing errors and providing real-time support to end users enjoying Zigbee installations.



**Help me by Somfy** is an app that provides step-by-step guidance when installing Somfy products - no need for paper manuals, regardless of the project.

Reduce the risk of errors, stop wasting time, and enjoy successful motorization installations.



Somfy's e-learning platform provides access to on-demand training, as well as live training events.

With **Somfy U**, you and your employees can learn about Somfy product and technologies. Plus, be eligible to earn rewards for learning about Somfy solutions upon completion of your first class.



**The Somfy Expert Program** is designed with a single goal in mind: to help your business thrive.

Our program provides specialized tools, direct support, and on-demand training featuring a growing range of smart home solutions. The Somfy Expert program is designed to help grow your business by creating a smarter, more efficient home for your customers.

**A committed customer support team of Somfy motor and control specialists available for assistance:**

## General Customer Service

877-210-5327 • [customerservice\\_us@somfy.com](mailto:customerservice_us@somfy.com)

### Somfy Corporate Headquarters

800-22-SOMFY (76639)

### Standard Purchase Order

[ordering\\_us@somfy.com](mailto:ordering_us@somfy.com)

### Rush Purchase Order

[expeditedshippingorders\\_us@somfy.com](mailto:expeditedshippingorders_us@somfy.com)

### Accounting Inquiries

[accountsreceivable@somfy.com](mailto:accountsreceivable@somfy.com)

### Technical Support

877-233-0019

[technicalsupport\\_us@somfy.com](mailto:technicalsupport_us@somfy.com)

### Warranty Claim Requests

[us\\_return@somfy.com](mailto:us_return@somfy.com)



Somfy understands that training and support are critical to success. Somfy's Expert Program has been developed to provide a platform for those who want to enhance their expertise of motorization and control solutions. Visit [www.somfypro.com](http://www.somfypro.com) to learn more and sign up for training.

# Somfy's 40mm Motor Range

---

This document is a presentation of accessories and specifications related to the Sonesse® 40, Altus® 40 RTS, and LS 40 Wired motors. It provides the technical information needed to order, fabricate, and sell the complete range of Somfy's 40 mm motors. For additional information regarding any of the products in this document including motors, power sources, controls, interfaces, etc., please reference [www.somfysystems.com](http://www.somfysystems.com) where detailed instructions are available for download.

## **Conveniently Quiet - Sonesse® 40**

The Sonesse® 40 Range with patent pending technology features a newly designed brake, rotor and gearbox to further reduce motor operating sound. Available in Zigbee, PoE, RS485, WT, and RTS technologies, the Sonesse 40 can be used in a variety of interior window covering applications.

## **Power, Simplicity, and Convenience - Altus® 40 (RTS)**

The Altus® 40 RTS features an integrated radio receiver within the motor which eliminates any wiring between the motor and controls. Available in two torques 4Nm and 9Nm, the Altus 40 RTS is ideal for exterior product applications.

## **Proven Strength and Reliability – LS 40 (Wired)**

The LS 40 motor is Somfy's original 40 mm solution. This robust and durable motor is available in a wide variety of torques and speeds and is a dependable source for exterior applications.

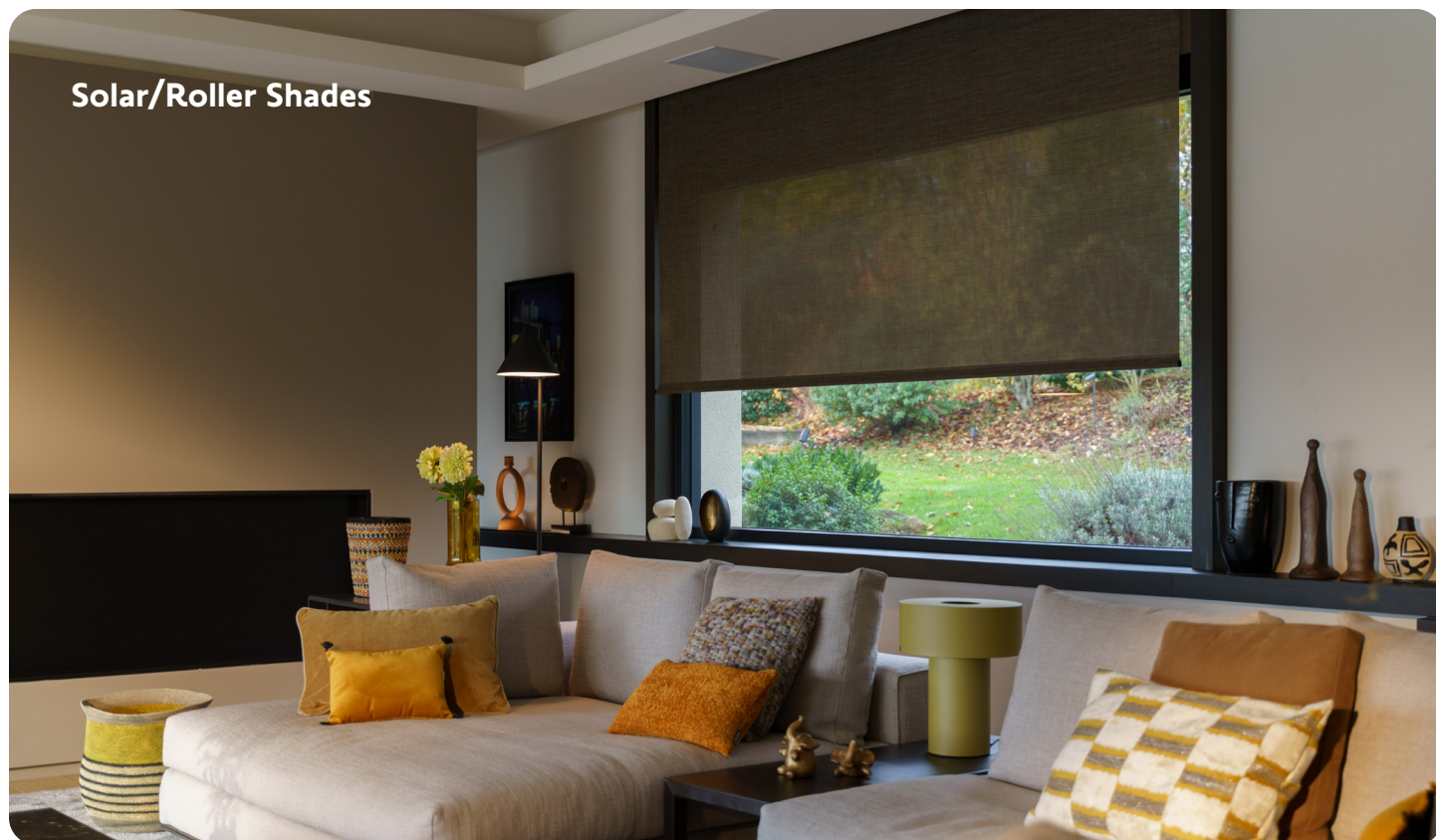





## Sheer Horizontal Shades



Globally adopted IoT control solution



## Roman/Woven Shades



Low-voltage control utilizing CAT-5e



## Horizontal Blinds



Commercial Building Control



## Awnings



Offers control via standard AC switching



## Rolling Shutters



Radio Technology Somfy® (RTS) allows wireless radio control



## Exterior Solar Screens



As with all Somfy products, motors are backed by a 5 year warranty

# Sonesse® 40

Designed to set the new acoustic standard.

**The most compact, adaptable and quiet 40 mm AC motor dedicated to interior window coverings.**

The Sonesse® 40 range features 4 patents pending that reduce motor operating sound. The brake, rotor, and gearbox are all specially designed to absorb sources of noise. It motorizes a variety of applications, and available in multiple technologies. Somfy offers a full range of compatible controls and accessories.

## SOMFY DESIGNED FOR SILENCE - Quietness Scale



Somfy  
DESIGNED FOR  
SILENCE

The Sonesse® range of motors are rated according to their quietness. The volume scale below appears on all Sonesse range specification pages and designates the motor's level of sound output.



Situo 5 Variation RTS  
Hand-held Remote

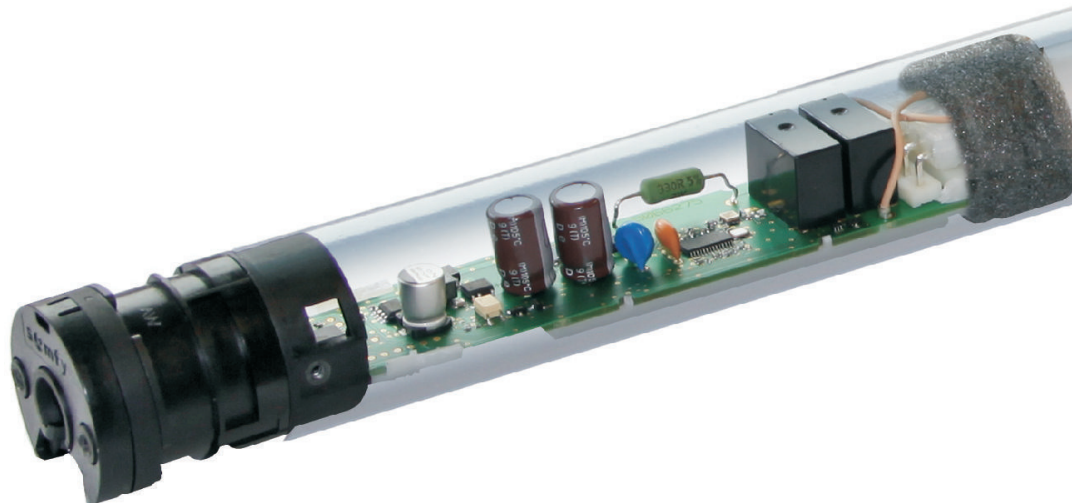

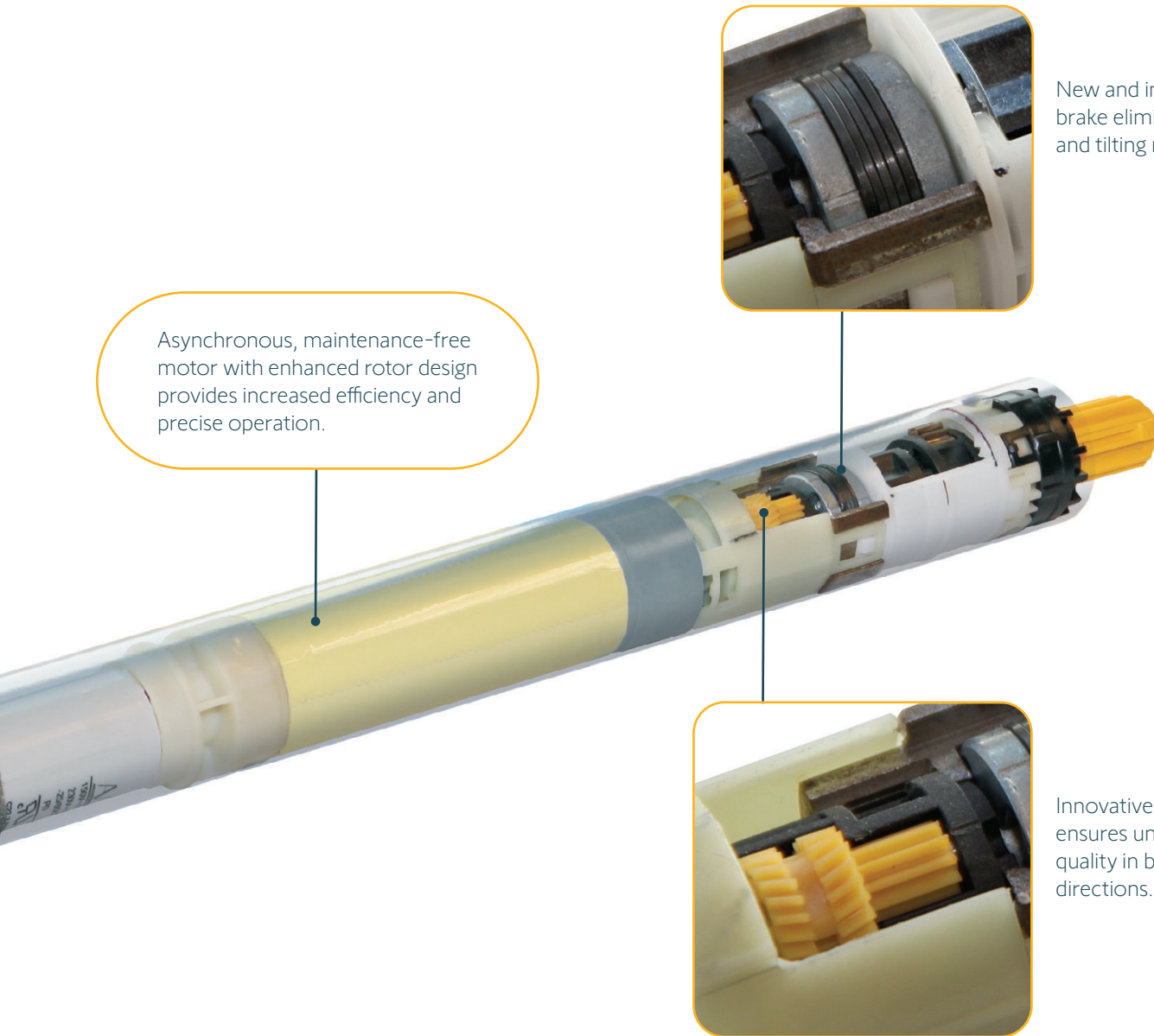

Asynchronous, maintenance-free motor with enhanced rotor design provides increased efficiency and precise operation.

New and improved spring brake eliminates stopping and tilting noise.

Innovative helical gearbox ensures uniform sound quality in both up and down directions.

# Sonesse® 40 AC Zigbee

Item #: 1245920 Sonesse® 40 Zigbee 404S2 with Fast Connector  
 Item #: 1245921 Sonesse® 40 Zigbee 406A2 with Fast Connector  
 Item #: 1245922 Sonesse® 40 Zigbee 409R2 with Fast Connector



Somfy  
DESIGNED FOR  
SILENCE



## Technical Features

<b>Voltage Supply</b>	120V/60Hz AC
<b>Index Protection Rating</b>	IP 31 (for indoor use only)
<b>Limit Switch Type</b>	Electronic
<b>Limit Switch Capacity</b>	250 turns
<b>Temperature Working Range</b>	32°F to 140°F (0°C to 60°C)
<b>Insulation Class</b>	Class II
<b>Thermal Protection</b>	4 minutes
<b>Repeatability</b>	+/-4°

**Antenna** 6.9 in. (17.5cm) wire length, must not be cut or lengthened. For greatest RF range, antenna must be out of the rail/tube/cassette.

## Dimensions

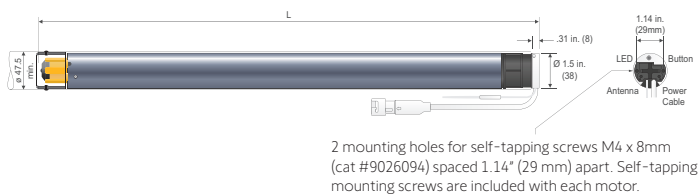

## Specifications

<b>Torque (Nm)</b>	4	6	9
<b>Speed (rpm)</b>	36	24	14
<b>Motor Length (L) in./mm</b>	20.2 in. (514mm)	21.5 in. (545mm)	
<b>Rated Current (Amp)</b>	0.79	1	1
<b>Radio Frequency</b>	2.4 GHz		
<b>Radio Protocol</b>	Zigbee 3.0 / Bluetooth 4.2		
<b>Stand By Consumption (W)</b>	0.5		
<b>Sound Level dB(A)*</b>	42	44	40

### \*Sound level:

Power Level: according to standards ISO3741 in dB(A) ref 1pW typical value, at nominal torque and nominal speed, without application/end product.

### Fabrication recommendations:

- Operational noise level is reduced when motor, tube, and mechanical accessories are properly adapted to motorized applications.
- Free play must be minimized between the accessories and the end product tube to ensure quiet performance of the motor.
- Inside Tube Diameter (ID) > or = 38mm must be respected to prevent contact with the basic motor tube.
- 400 Series Drive Stop and Screw (#9147894) is recommended to prevent noise and drive wheel separation from motor shaft.

## Optional Head Covers



Optional Grey  
#9026091



Optional Black  
#9026092



White  
(supplied with motor)  
#9026090

## Applications



Roller shades



Roman shades



Woven woods



Pleated shades\*



Cellular shades\*



Layered/  
Zebra shades\*



Projection  
screens



Horizontal  
blinds\*

\*Using CTS40

## Main Functionalities



Designed for silence



Position feedback



Openness of the Zigbee  
protocol



Quick & easy settings



Mesh network router



"my" function



Tilting



Works with  
Apple Home

## Integrated Motor Plates (sold separately)

<b>9025997</b>	Sonesse 40 Motor Plate Rollease R16-24 15.9 x 1.8mm & screws	
<b>9026000</b>	Sonesse 40 Motor Plate Rollease RBGAL 16 x 3.2mm & screws	
<b>9025996</b>	Sonesse 30 Motor Plate Rollease 360 R3-R8 10 x 1.8mm and screws	
<b>9025999</b>	Sonesse 30 Motor Plate Acmeda 12mm and screws	
<b>9026003</b>	Sonesse 30 Motor Plate Rollease Skyline and screws	
<b>9026093</b>	Sonesse 30 Motor Plate M3 x 6mm Philips flat-head plastite screw	

## Cables

Cable type: White 2-conductor SVT 2 - AWG 18 : 0.824 mm² / Fast Connector 7.9 in. (20cm)



## Certifications



# Sonesse® 40 PoE

Item #: 1241426 Sonesse 40 PoE at 2/25 Type 2 (30W)  
 Item #: 1241427 Sonesse 40 PoE bt 4/25 Type 3 (60W)  
 Item #: 1241428 Sonesse 40 PoE bt 6/25 Type 4 (75W)



## Technical Features

<b>Voltage Supply &amp; Tolerance</b>	48V DC (42.5V DC – 57V DC)
<b>Thermal run time</b>	5 minutes
<b>Repeatability</b>	+/- 5°
<b>Index Protection Rating</b>	IP30 (interior use only)
<b>Limit Switch Unit</b>	Electronic
<b>Temperature Working Range</b>	From 32°F to 140°F (0°C to 60°C)
<b>Insulation Class</b>	Class III
<b>Max Distance from Power Source</b>	328 ft. (100m)

## Dimensions

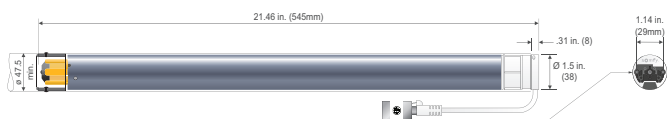

2 mounting holes for self-tapping screws M3.5x9mm (cat #9014066) spaced 1.14 in. (29mm) apart.

## Specifications

<b>Nominal Torque (Nm)</b>	2	4	6
<b>Power Supply (IEEE 802.3bt)</b>	Type 2 (30W)	Type 3 (60W)	Type 4 (75W)
<b>Nominal Speed (rpm)</b>	25		
<b>Rated Power (W)</b>	25	51	62
<b>Protocol</b>	Somfy Synergy™ API, CoAP		
<b>Security</b>	Certificate + PIN code to secure TCP/TLS AES-128 encryption over UDP		
<b>Stand By Consumption (W)</b>	<1 W		
<b>Sound Level dB(A)*</b>	41	42	47

### \*Sound level:

Power Level: according to standards ISO3741 in dB(A) ref 1pW typical value, at nominal torque and nominal speed, without application/end product.

### Fabrication recommendations:

- Operational noise level is reduced when motor, tube, and mechanical accessories are properly adapted to motorized applications.
- Free play must be minimized between the accessories and the end product tube to ensure quiet performance of the motor
- Inside Tube Diameter (ID) > or = 38mm must be respected to prevent contact with the basic motor tube.
- 400 Series Drive Stop and Screw (#9147894) is recommended to prevent noise and drive wheel separation from motor shaft.

## Applications



Roller shades



Roman shades



Layered/  
Zebra shades\*



Sheer horizontals



Horizontal blinds\*



Projection screens

## Main Functionalities



Designed for silence



Thin head



Adjustable speed



Built-in speed control



Position feedback



LED provides feedback on motor



Motor unique identifier



Soft start and soft stop

## Integrated Motor Plates (sold separately)

<b>9025997</b>	Sonesse 40 Motor Plate Rollease R16-24 15.9 x 1.8mm & screws	
<b>9026000</b>	Sonesse 40 Motor Plate Rollease RBGAL 16 x 3.2mm & screws	
<b>9025996</b>	Sonesse 30 Motor Plate Rollease 360 R3-R8 10 x 1.8mm and screws	
<b>9025999</b>	Sonesse 30 Motor Plate Acmeda 12mm and screws	
<b>9026003</b>	Sonesse 30 Motor Plate Rollease Skyline and screws	
<b>9026093</b>	Sonesse 30 Motor Plate M3 x 6mm Philips flat-head plastite screw	

## Cables

CAT-5e SF/UTP — RJ45 7.5 in. (19cm) pigtail with RJ45 shielded female to female coupler, #9028957



## Optional Head Covers



Optional Grey  
#9027133



Optional Black  
#9027134



White (supplied with motor)  
#9027132



# Sonesse® 40 RS485

Item #: 1240562 Sonesse® 40 RS485 404S2 without Fast Connector  
 Item #: 1240563 Sonesse® 40 RS485 406A2 without Fast Connector  
 Item #: 1240564 Sonesse® 40 RS485 409R2 without Fast Connector



Somfy  
DESIGNED FOR  
SILENCE



## Technical Features

<b>Voltage Supply</b>	120V/60Hz AC
<b>Index Protection Rating</b>	IP 31 (for indoor use only)
<b>Limit Switch Type</b>	Electronic
<b>Limit Switch Capacity</b>	250 turns
<b>Temperature Working Range</b>	32°F to 140°F (0°C to 60°C)
<b>Insulation Class</b>	Class II
<b>Thermal Protection</b>	4 minutes
<b>Repeatability</b>	+/- 4°

## Dimensions



2 mounting holes for self-tapping screws M4 x 8mm (cat #9026094) spaced 1.14" (29 mm) apart. Self-tapping mounting screws are included with each motor.

## Specifications

Torque (Nm)	4	6	9
Speed (rpm)	36	24	14
Motor Length (L) in./mm	20.2 in. (514mm)	21.5 in. (545mm)	
Rated Current (Amp)	0.95		
Stand By Consumption (W)	0.5		
Sound Level dB(A)*	42	44	40

### \*Sound level:

Power Level: according to standards ISO3741 in dB(A) ref 1pW typical value, at nominal torque and nominal speed, without application/end product.

### Fabrication recommendations:

- Operational noise level is reduced when motor, tube, and mechanical accessories are properly adapted to motorized applications.
- Free play must be minimized between the accessories and the end product tube to ensure quiet performance of the motor
- Inside Tube Diameter (ID) > or = 38mm must be respected to prevent contact with the basic motor tube.
- 400 Series Drive Stop and Screw (#9147894) is recommended to prevent noise and drive wheel separation from motor shaft.

## Optional Head Covers



Optional Grey  
#9026091



Optional Black  
#9026092



White  
(supplied with motor)  
#9026090

## Applications



Roller shades



Pleated shades\*



Roman shades



Horizontal blinds\*



Layered/Zebra shades\*



Projection screens

## Main Functionalities



Designed for silence



Thin head



LED provides feedback on motor



Easy limit setting



Position feedback



Motor unique identifier

## Integrated Motor Plates (sold separately)

<b>9025997</b>	Sonesse 40 Motor Plate Rollease R16-24 15.9 x 1.8mm & screws	
<b>9026000</b>	Sonesse 40 Motor Plate Rollease RBGAL 16 x 3.2mm & screws	
<b>9025996</b>	Sonesse 30 Motor Plate Rollease 360 R3-R8 10 x 1.8mm and screws	
<b>9025999</b>	Sonesse 30 Motor Plate Acmeda 12mm and screws	
<b>9026003</b>	Sonesse 30 Motor Plate Rollease Skyline and screws	
<b>9026093</b>	Sonesse 30 Motor Plate M3 x 6mm Philips flat-head plastite screw	

## Cables

Cable type: white 2 conductor SVT 9.8 ft (3m) AWG 18

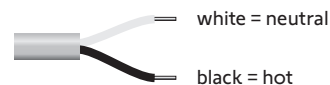

Cable type: white 11.8 in. (30cm) RJ45 male with RJ45 Female/Female coupler part# 9026095

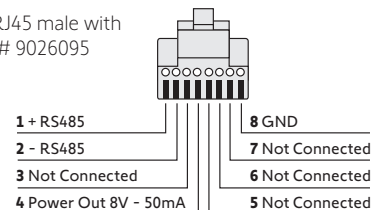

## Certifications



# Sonesse® 40 WT

404S2 1240377    409R2 1240379  
406A2 1240378



Somfy  
DESIGNED FOR  
SILENCE



Offers control via  
power switching

## Technical Features

<b>Voltage Supply</b>	120V AC	<b>Limit Switch Capacity</b>	40 Turns
<b>Index Protection Rating</b> (interior use only)	Motor: IP 44 Fast Connector: IP55	<b>Temperature Working Range</b>	32°F to 140°F (0°C to 60°C)
<b>Limit Switch Type</b>	Progressive Adjustment (PA)	<b>Insulation Class</b>	Class 1 for 120V AC

## Dimensions

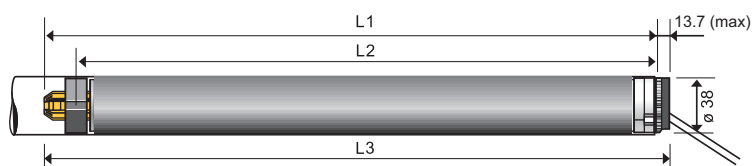

NOTE: Illustration dimensions in millimeters (mm).

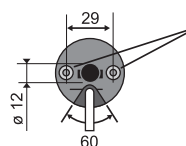

2 mounting holes for self tapping screws. Dia. 4 mm (cat #100405B)  
Depth 9 mm spaced 1.14" (29 mm) apart.  
Self tapping mounting screws are included with each motor.

	404S2	406A2	409R2
<b>L1</b>	18.19 in. (462 mm)	19.45 in. (494 mm)	19.45 in. (494 mm)
<b>L2</b>	17.36 in. (441 mm)	18.62 in. (473 mm)	18.62 in. (473 mm)
<b>L3</b>	18.82 in. (478 mm)	20.08 in. (510 mm)	20.08 in. (510 mm)
<b>Cable Length</b>	1.6 ft (.5 m) to Fast Connector		

## Certifications



## Specifications

	404S2	406A2	409R2
<b>Torque</b>	4 Nm	6 Nm	9 Nm
<b>Nominal Voltage</b>	120V / 60Hz		
<b>Rated Current</b>	.95A		
<b>Speed</b>	36 rpm	24 rpm	14 rpm
<b>Thermal Protection</b>	4 minutes		
<b>*Sound Level</b>	42 dBA	44 dBA	40 dBA

### \*Sound level:

\*According to standards ISO 3741 NF 31022 in dBA ref 1pW at nominal torque without end product.

### Fabrication recommendations:

- Operational noise level is reduced when motor, tube, and mechanical accessories are properly adapted to motorized applications.
- Free plays have to be minimized between the accessories and the end product tube to ensure quiet performance of the motor.
- Interior Tube Diameter (ID) > or = 38mm must be respected to prevent contact with the basic motor tube.
- 400 Series Drive Stop and Screw (9147894) is recommended to prevent noise and drive wheel separation from motor shaft.



## Type of power cable

### Wired

#### 120V AC / 60Hz

4-Conductor 1.6 ft. SJTW Cable on  
Motor with Fast Connector



## Extension Cable (sold separately)



### 4 Conductor Fast Connector

#### Extension Cable with Open Leads

9021117	4.4 ft.
9021118	8.4 ft.
9021120	16.4 ft.
9021121	22.4 ft.

# Sonesse® 40 RTS

404S2 1240380 409R2 1240382  
406A2 1240381



Somfy  
DESIGNED FOR  
SILENCE



Offers control via Radio  
Technology Somfy® (RTS)

## Technical Features

<b>Voltage Supply</b>	120V AC	<b>Temperature Working Range</b>	32°F to 140°F (0°C to 60°C)
<b>Index Protection Rating</b> (interior use only)	Motor: IP 44 Fast Connector: IP55	<b>Insulation Class</b>	Class 1 for 120V AC
<b>Limit Switch Type</b>	Electronic (RTS)	<b>Antenna</b>	Integrated into power cord. Power cord must be at least 12 inches and must not come in contact with metal.
<b>Limit Switch Capacity</b>	200 Turns		

## Dimensions

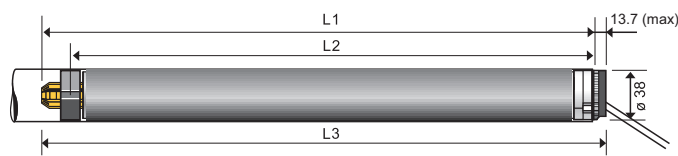

NOTE: Illustration dimensions in millimeters (mm).

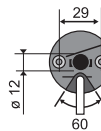

2 mounting holes for self tapping screws. Dia. 4 mm (cat #100405B)  
Depth 9 mm spaced 1.14" (29 mm) apart.  
Self tapping mounting screws are included with each motor.

	404S2	406A2	409R2
<b>L1</b>	19.96 in. (507 mm)	21.18 in. (538 mm)	21.18 in. (538 mm)
<b>L2</b>	19.00 in. (483 mm)	20.24 in. (514 mm)	20.24 in. (514 mm)
<b>L3</b>	20.5 in. (520 mm)	21.69 in. (551 mm)	21.69 in. (551 mm)
<b>Cable Length</b>	1.6 ft (.5 m) to Fast Connector		

## Certifications



## Specifications

	404S2	406A2	409R2
<b>Torque</b>	4 Nm	6 Nm	9 Nm
<b>Nominal Voltage</b>	120V / 60Hz		
<b>Rated Current</b>	.95A		
<b>Speed</b>	36 rpm	24 rpm	14 rpm
<b>Thermal Protection</b>	4 minutes		
<b>Radio Frequency</b>	433.42 MHz		
<b>*Sound Level</b>	42 dBA	44 dBA	40 dBA

### Sound level:

\*According to standards ISO 3741 NF 31022 in dBA ref 1pW at nominal torque without end product.

### Fabrication recommendations:

- Operational noise level is reduced when motor, tube, and mechanical accessories are properly adapted to motorized applications.
- Free plays have to be minimized between the accessories and the end product tube to ensure quiet performance of the motor.
- Interior Tube Diameter (ID) > or = 38mm must be respected to prevent contact with the basic motor tube.
- 400 Series Drive Stop and Screw (9147894) is recommended to prevent noise and drive wheel separation from motor shaft.



## Type of power cable

### RTS

#### 120V AC / 60Hz

3-Conductor 1.6 ft. SJTW Cable on Motor with Fast Connector



## Extension Cable (sold separately)

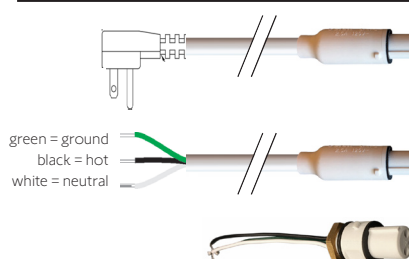

### 3 Conductor Fast Connector Extension Cable with NEMA Plug (RTS & RS485)

9021113	1.4 ft.	9021114	4.4 ft.
9021115	8.4 ft.	9020791	10.4 ft.
9020792	18 ft.	9020793	24 ft.

### 3 Conductor Fast Connector Extension Cable with Open Leads or No NEMA

9021157	8.4 ft.
---------	---------

### 3 Conductor Panel Mount Female Fast Connector for direct connection to J-Box

9026398	Panel Mount Female Fast Connector
---------	-----------------------------------

# LS 40 WT

412R2 1024192



Offers control via power switching

## Technical Features

<b>Voltage Supply</b>	120V AC	<b>Limit Switch Capacity</b>	40 Turns
<b>Index Protection Rating</b>	IP 44	<b>Temperature Working Range</b>	32°F to 140°F (0°C to 60°C)
<b>Limit Switch Type</b>	Progressive Adjustment (PA)	<b>Insulation Class</b>	Class 1 for 120V AC

## Dimensions

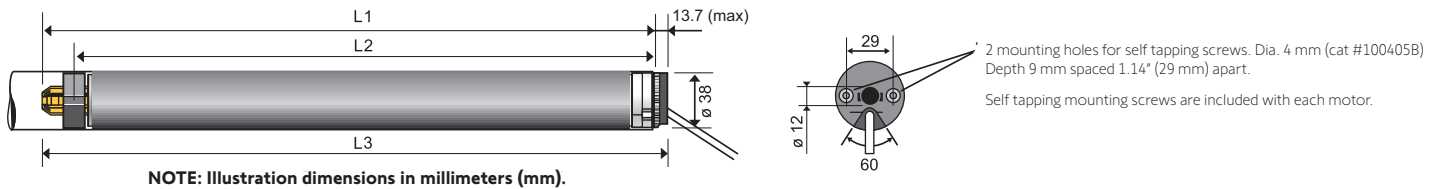

	404S2	404R2	409R2	412R2
<b>L1</b>	18.46 in. (469 mm)	18.46 in. (469 mm)	18.46 in. (469 mm)	18.46 in. (469 mm)
<b>L2</b>	17.64 in. (448 mm)	17.64 in. (448 mm)	17.64 in. (448 mm)	17.64 in. (448 mm)
<b>L3</b>	19.09 in. (485 mm)	19.09 in. (485 mm)	19.09 in. (485 mm)	19.09 in. (485 mm)
<b>Cable Length</b>	6.5 ft (2 m)			

## Specifications

	404S2	404R2	409R2	412R2
<b>Torque</b>	4 Nm	4 Nm	9 Nm	12 Nm
<b>Nominal Voltage</b>	120V / 60Hz			
<b>Rated Current</b>	.95A	.85A	1.05A	1.05A
<b>Speed</b>	36 rpm	18 rpm	18 rpm	10 rpm
<b>Thermal Protection</b>	5 minutes			
<b>*Sound Level</b>	57 dBA	57 dBA	54 dBA	54 dBA

### \*Sound level:

\*According to standards ISO 3741 NF 31022 in dBA ref 1pW at nominal torque without end product.

### Fabrication recommendations:

- Operational noise level is reduced when motor, tube, and mechanical accessories are properly adapted to motorized applications.
- Free plays have to be minimized between the accessories and the end product tube to ensure quiet performance of the motor.
- Interior Tube Diameter (ID) > or = 38mm must be respected to prevent contact with the basic motor tube.
- 400 Series Drive Stop and Screw (9147894) is recommended to prevent noise and drive wheel separation from motor shaft.

## Type of power cable

**Wired**  
**120V AC / 60Hz**  
4-Conductor Cable

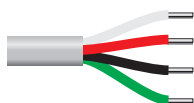

white = neutral  
red = direction 1  
black = direction 2  
green = ground

## Certifications



# Altus® 40 RTS

404S2 1240260 409R2 1240261



Somfy  
DESIGNED FOR  
SILENCE



Offers control via Radio  
Technology Somfy® (RTS)

## Technical Features

<b>Voltage Supply</b>	120V AC	<b>Temperature Working Range</b>	14°F to 104°F (-10°C to 40°C)
<b>Index Protection Rating</b>	Motor: IP 44 Fast Connector: IP55	<b>Insulation Class</b>	Class 1 for 120V AC
<b>Limit Switch Type</b>	Electronic (RTS)	<b>Antenna</b>	Integrated into power cord. Power cord must be at least 12 inches and must not come in contact with metal.
<b>Limit Switch Capacity</b>	200 Turns		

## Dimensions

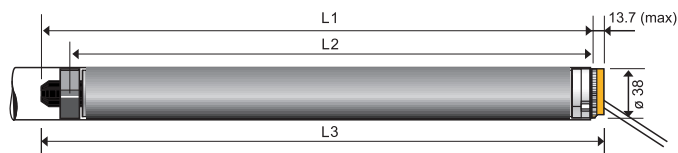

NOTE: Illustration dimensions in millimeters (mm).

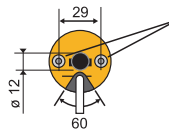

2 mounting holes for self tapping screws. Dia. 4 mm (cat #100405B)  
Depth 9 mm spaced 1.14" (29 mm) apart.  
Self tapping mounting screws are included with each motor.

	404S2	409R2
<b>L1</b>	20.08 in. (510 mm)	20.87 in. (530 mm)
<b>L2</b>	19.13 in. (486 mm)	19.92 in. (506 mm)
<b>L3</b>	20.59 in. (523 mm)	21.38 in. (543 mm)
<b>Cable Length</b>	1.6 ft (.5 m) to Fast Connector	

## Certifications



## Specifications

	404S2	409R2
<b>Torque</b>	4 Nm	9 Nm
<b>Nominal Voltage</b>	120V / 60Hz	
<b>Rated Current</b>	.95A	1.05A
<b>Speed</b>	36 rpm	18 rpm
<b>Thermal Protection</b>	5 minutes	
<b>Radio Frequency</b>	433.42 MHz	
<b>*Sound Level</b>	57 dBA	54 dBA

### Sound level:

\*According to standards ISO 3741 NF 31022 in dBA ref 1pW at nominal torque without end product.

### Fabrication recommendations:

- Operational noise level is reduced when motor, tube, and mechanical accessories are properly adapted to motorized applications.
- Free plays have to be minimized between the accessories and the end product tube to ensure quiet performance of the motor.
- Interior Tube Diameter (ID) > or = 38mm must be respected to prevent contact with the basic motor tube.
- 400 Series Drive Stop and Screw (9147894) is recommended to prevent noise and drive wheel separation from motor shaft.

## Type of power cable

### RTS

#### 120V AC / 60Hz

3-Conductor 1.6 ft. SJTW Cable on  
Motor with Fast Connector



## Extension Cable (sold separately)

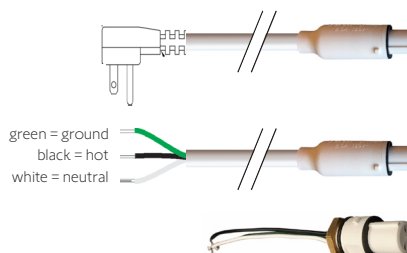

### 3 Conductor Fast Connector Extension Cable with NEMA Plug (RTS & RS485)

9021113	1.4 ft.	9021114	4.4 ft.
9021115	8.4 ft.	9020791	10.4 ft.
9020792	18 ft.	9020793	24 ft.

### 3 Conductor Fast Connector Extension Cable with Open Leads or No NEMA

9021157	8.4 ft.
---------	---------

### 3 Conductor Panel Mount Female Fast Connector for direct connection to J-Box

9026398	Panel Mount Female Fast Connector
---------	-----------------------------------



# Controls

## Zigbee® Technology

### TaHoma® switch



TaHoma® switch  
1871037  
TaHoma® switch  
(with ethernet adaptor)  
1871038



TaHoma® switch  
Ethernet Adaptor  
9028054

### Smart Plug



Smart Plug Zigbee  
1871217

### DecoFlex WireFree™ Wall Switches



DecoFlex WireFree™ Zigbee,  
White 2 Channel  
Surface-mount  
1871577  
In-wall  
1871573



DecoFlex WireFree™ Zigbee,  
White 4 Channel  
Surface-mount  
1871576  
In-wall  
1871572



## Ysia®



Ysia® 1 Zigbee  
1871153



Ysia® 5 Zigbee  
1871154



Ysia® 5 Variation Zigbee  
1871281

## Izmo



Izmo™ Motor Receiver Zigbee  
1871259



Izmo™ Lighting Receiver Zigbee  
1871260

## Power over Ethernet Technology

### PoE Controls

The SDN PoE Controls utilize PoE technology to power and control the Somfy® 24V RS485 motors for shades and draperies.

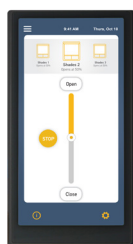

PoE Touch Panel  
Room Controller Black  
1870731

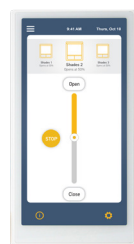

PoE Touch Panel Room  
Controller White  
1870811

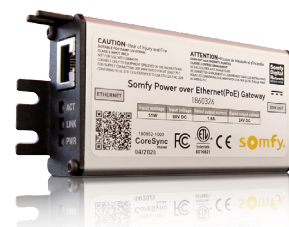

SDN Power over Ethernet  
(PoE) Gateway  
1860326



# Controls

## Integration Accessories

### Somfy Connect™ Universal Automation Interface (UAI) Plus



The Somfy Connect™ Universal Automation Interface (UAI) Plus allows for commissioning and integrating Somfy Digital Network™ (SDN) over IP.

1870272

### Somfy Connect™ BMS Interface



Provides communication between building management systems and SDN motorized shading systems.

1871168



## Somfy Digital Network™ (SDN) RS485

### Surface-mount Power Panel

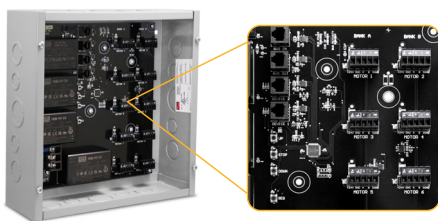

SDN PowerConnect™ Surface-Mount Panel

This Power Panel is an SDN bus distribution component used to add 10 isolated motor ports and two isolated device ports to an SDN bus segment.

1871026

### Rack-mount Power Panels



SDN PowerConnect™ Rack-Mount Panel

This Power Panel is an SDN bus distribution device used to add eight isolated motor ports and two isolated device ports to an SDN bus segment per panel.

Single Kit: 1871027

Dual Kit: 1871312



### Data Panel



The Data Panel is a bus distribution component used to start or grow a Somfy Digital Network™ (SDN) system. This device adds 4 isolated bus segments to an SDN system.

1870260

### Data Hub V2



The Data Hub V2 is a Somfy Digital Network™ (SDN) bus distribution component which adds 5 device ports to an SDN Bus line.

1870951

### Bus & Sensor Station Power Supply



The Somfy Bus and Sensor Station Power Supply provides 24V DC power to the SDN bus. Each Power Supply can provide power to up to 100 bus line devices (excluding motors).

1822440

# Controls

## Somfy Digital Network™ (SDN) RS485



### SDN 0-10V Interface

### RTS Receiver for SDN and animeo® IP



SDN 0-10V Interface V2

The 0-10V Interface is a Somfy Digital Network™ (SDN) device which receives industry standard 0-10V control input to operate SDN RS485 motors.

1870857



RTS Receiver for SDN V2

The RTS Receiver for SDN V2 allows RTS transmitters to control SDN groups as part of a stand-alone SDN system. It connects to any device port on the SDN bus for both power and communication.

1871471

RTS Receiver for animeo® IP V2

The RTS Receiver for animeo® IP provides communication between building management systems and SDN motorized shading systems.

1871498

## DecoFlex Digital Keypads (RS485)



### Stand-alone SDN

### SDN Group Keypads

### animeo® IP



6 Button  
White: 1871479  
Black: 1871495



8 Button  
White: 1871472  
Black: 1871494

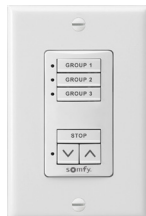

6 Button  
White: 1871497



8 Button  
White: 1871496



6 Button  
White: 1871493  
Black: 1871492



8 Button  
White: 1871491  
Black: 1871490

NOTE: Custom button ordering form available at [www.somfypro.com/decoflex-custom-button](http://www.somfypro.com/decoflex-custom-button)  
Visit tools page for software to configure keypads, [www.somfypro.com/services-support/software](http://www.somfypro.com/services-support/software)

## animeo® IP



animeo® IP is a total solar management system utilizing Somfy-powered intelligent motorized window coverings as well as digital keypads and weather sensors. The system's controllers, sensors and keypads can be added to both new and existing Somfy Digital Network installations for comprehensive solar management as either a stand-alone solution or integrated into third-party control systems. An intuitive user interface allows for simplified commissioning, building management and technical support, featuring drag-and-drop programming, motor auto discovery and at-a glance system status update.



animeo® IP Building Controller  
1822314

animeo® IP Sub-Controller  
1860201

# Controls

## Radio Technology Somfy® (RTS)



### Situo & Telis Collections



Situo° 1 RTS  
Pure Single  
Channel Remote  
1870571



Situo° 5 RTS  
Pure Five  
Channel Remote  
1870575



Situo° 1 RTS  
Iron Single  
Channel Remote  
1870572



Situo° 5 RTS  
Iron Five  
Channel Remote  
1870576



Situo° 1 RTS  
Natural Single  
Channel Remote  
1870573



Situo° 5 RTS  
Natural Five  
Channel Remote  
1870577



Situo° 1 RTS  
Arctic Single  
Channel Remote  
1870574



Situo° 5 RTS  
Arctic Five  
Channel Remote  
1870578



Situo° 5 RTS  
Soliris Five  
Channel Remote  
1870579



Situo° 5 RTS  
Variation Five  
Channel Remote  
1811612



Telis 1 RTS Patio  
Single Channel  
Remote  
1810643



Telis 4 RTS Patio  
Five Channel  
Remote  
1810645



Telis 16 Channel RTS  
Pure Remote with  
On-screen display  
1811081



Telis 16 Channel RTS  
Silver Remote with  
On-screen display  
1811082



Telis 1 Chronis RTS  
Pure Timer with  
On-screen display  
1805237

### DecoFlex WireFree™ Wall Switches



DecoFlex 1  
Channel RTS  
WireFree™ Wall Switch  
White  
1810897  
Black  
1810899



DecoFlex 2  
Channel RTS  
WireFree™ Wall Switch  
White  
1811068  
Black  
1811067



DecoFlex 3  
Channel RTS  
WireFree™ Wall Switch  
White  
1811071  
Black  
1811070



DecoFlex 4  
Channel RTS  
WireFree™ Wall Switch  
White  
1811074  
Black  
1811073



DecoFlex 5  
Channel RTS  
WireFree™ Wall Switch  
White  
1810813  
Black  
1810830



DecoFlex WireFree™  
3-Button  
White  
1870908



DecoFlex WireFree™  
Surface 5 Channel  
White  
1871025

- Wall Switches shown in white. Black finish is also available.
- Switches are shown assembled with printed channel buttons.
- Custom engraved buttons are also available.



Black

- Wall Switches are only available in white.

NOTE: For additional information regarding RTS controls, contact Somfy Systems, Inc.

# Controls

## Radio Technology Somfy® (RTS)



### Table Top Accessories



DecoFlex WireFree™  
RTS Table Top  
Accessory  
Black  
1811051\*



DecoFlex WireFree™  
RTS Table Top  
Accessory  
Silver  
1810972\*



DecoFlex WireFree™  
RTS Table Top  
Accessory  
White  
1811185\*

### Smoove® Wall Switches



Smoove® 1 RTS Pure II  
1871361

- Battery-operated convenience
- Surface mounts with ease
- Frames available in 3 colors



Smoove® 4 RTS Pure II  
1871381



\*DecoFlex Switch is sold separately from Table Top Accessory.

### TaHoma® switch



TaHoma® switch  
1871037

TaHoma® switch  
(with ethernet adaptor)  
1871038



TaHoma® switch  
Ethernet Adaptor  
9028054

### 16 Channel RTS Interface



Universal RTS Interface 16-Channel  
(converts IR, RS232, RS485 to RTS)  
1810872

### RTS Repeater



RTS Repeater  
(extends RTS range)  
1810791

NOTE: For additional information regarding RTS controls, contact Somfy Systems, Inc.



# Controls

## Wired AC Controls & Switches



### Decorator Toggle Switches (single pole, double throw) & Switchplates



Maintained  
Toggle Switch (White)  
1800381



Maintained  
Toggle Switch (Ivory)  
1800380



Momentary  
Toggle Switch (White)  
1800383



Momentary  
Toggle Switch (Ivory)  
1800382



Plastic Toggle  
Switchplate (White)  
9011963



Plastic Toggle  
Switchplate (Ivory)  
9011962

### Decorator Paddle Switches & Switchplates



Maintained Paddle Switch  
(White)  
1800374



Maintained Paddle Switch  
(Ivory)  
1800373



Momentary Paddle Switch  
(White)  
1800378



Momentary Paddle Switch  
(Ivory)  
1800377



Maintained Double Pole,  
Double Throw Paddle Switch  
(White)  
1800375



Maintained Double Pole,  
Double Throw Paddle Switch  
(Ivory)  
1800376



Single Gang Paddle Switchplate  
(White)  
9011967



Single Gang Paddle Switchplate  
(Ivory)  
9011966

### 5 Position Switch



5 Position AC Decorator  
Rocker Switch with Tilting Control  
(White)  
1800388



Decorator Rocker Switch  
Double Pole, Double Throw  
Maintained (White)  
1800341



Decorator Rocker Switch  
Double Pole, Double Throw  
Maintained (Ivory)  
1800342



Decorator Rocker Switch  
Double Pole, Double Throw  
Momentary (White)  
1800345

### Decorator/Designer Paddle Switches



Decorator/Designer Paddle Switch  
Single Pole Maintained  
(White)  
1800374



Decorator/Designer Paddle Switch  
Single Pole Maintained  
(Ivory)  
1800373



Decorator/Designer Paddle Switch  
Single Pole Momentary  
(White)  
1800378



Decorator/Designer Paddle Switch  
Single Pole Momentary  
(Ivory)  
1800377



Decorator/Designer Switch  
Maintained (Double Pole)  
(Ivory)  
1800376

# Controls

## Wired AC Controls & Switches



### Individual Group Control (IGC) 4n1 Motor Controller



IGC 4N1 Motor Controller  
1811416



IGC 4N1 RTS Radio Receiver  
1811492



DecoFlex Dry Contact Keypad  
1811402



IGC RTS Radio Receiver (Momentary)  
1810481

IGC 4N1 Motor Controller Shutter Mode  
1870902

### Group Control System II (GCS II)



Group Control System II (GCS II)  
1810476

## Dry Contact

## DRY CONTACT

### RTS Dry Contact Interface

### Outdoor Receivers

### Eolis Sensor

### Soliris Sensor



RTS Dry Contact Interface  
Single Channel  
1810493



Outdoor Lighting Receiver  
1810875  
Universal RTS Receiver  
1810627



Eolis RTS Wind  
Sensor 24V  
9012499



Soliris RTS Sun and  
Wind Sensor 24V  
9012500

# 40mm Hardware Systems

Acmeda®

## Standard Bracket Components

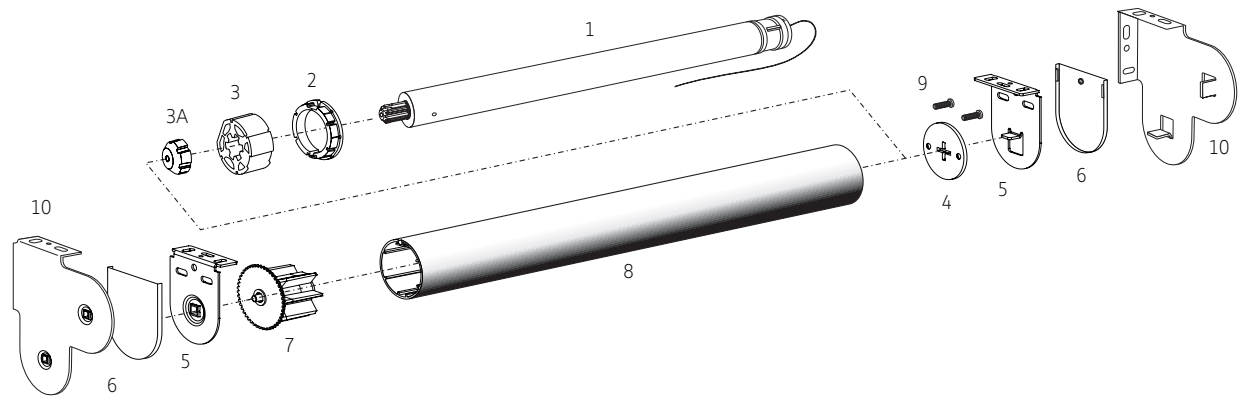

## Dimensions and Light Gap Specifications

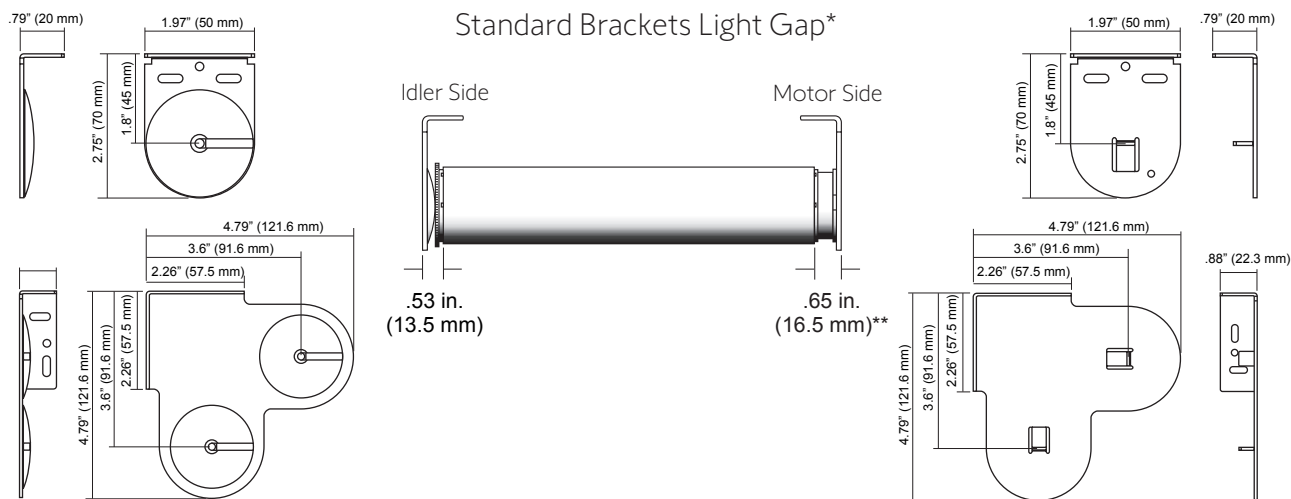

## Product Chart

Image	Description	Catalog Number
1	SONESSE® 40 MOTOR SHOWN	Refer to spec sheet by technology
2	CROWN ADAPTOR 44MM TUBE (ACMEDA® TYPE)	9013791
3	DRIVE WHEEL 44MM (ACMEDA® TYPE)	9013790
3A	400 SERIES DRIVE STOP WITH SCREW	9147894
4	MOTOR BRACKET ADAPTOR PLATE (ACMEDA® TYPE)	9013789
5	MOTOR & IDLER BRACKET KIT 40P (ACMEDA® TYPE)	9013778
6	PLASTIC BRACKET COVER 40P KIT (ACMEDA® TYPE)	9013780
7	IDLER END PLUG 44MM TUBE (ACMEDA® TYPE)	9013774
8	44 M ALUMINUM TUBE (16 FT. MAX LENGTH)	1780688
9	M3.5 X 9MM SCREWS	9014066
10	MOTOR BRACKET COMBO SET 122MM X 122MM	Contact Acmeda

# 40mm Hardware Systems

Acmeda®

## Standard Bracket Components

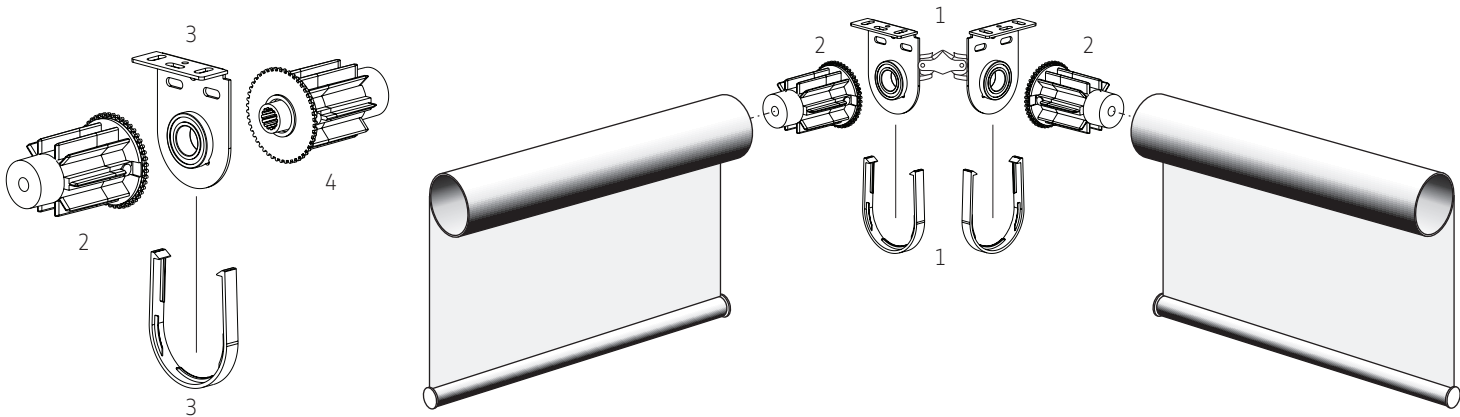

## Dimensions and Light Gap Specifications

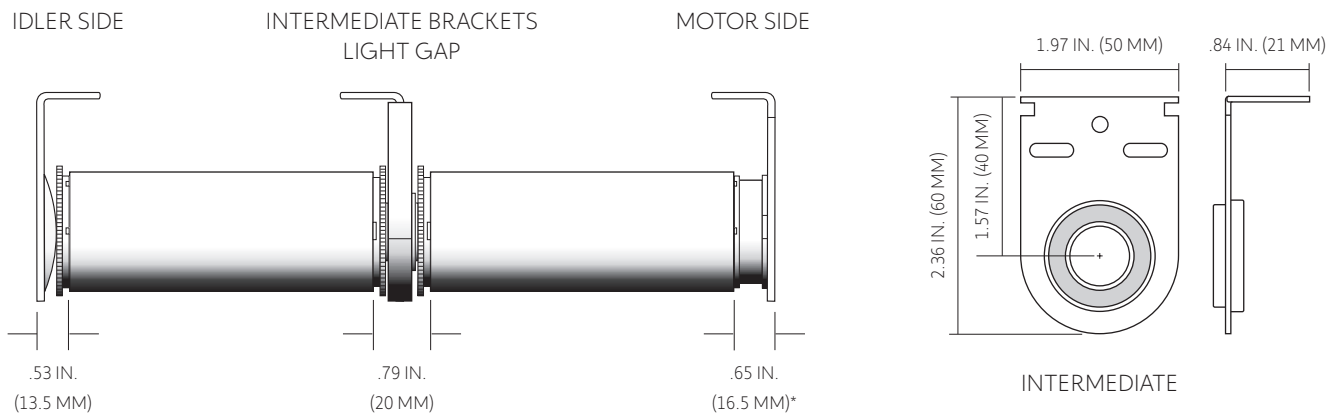

\* INCLUDES MOTOR BRACKET ADAPTOR PLATE  
#9013789

## Product Chart

Image	Description	Catalog Number
1	INTERMEDIATE BRACKET & COVER KIT 40P, 0-90 DEGREES (ACMEDA® TYPE)	Contact Acmeda
2	INTERMEDIATE MALE IDLER END PLUG (ACMEDA® TYPE)	Contact Acmeda
3	INTERMEDIATE BRACKET & COVER KIT 40P (ACMEDA® TYPE)	Contact Acmeda
4	INTERMEDIATE FEMALE IDLER END PLUG (ACMEDA® TYPE)	Contact Acmeda

# 40mm Hardware Systems

## Somfy Decorator Type

### Standard Bracket Components

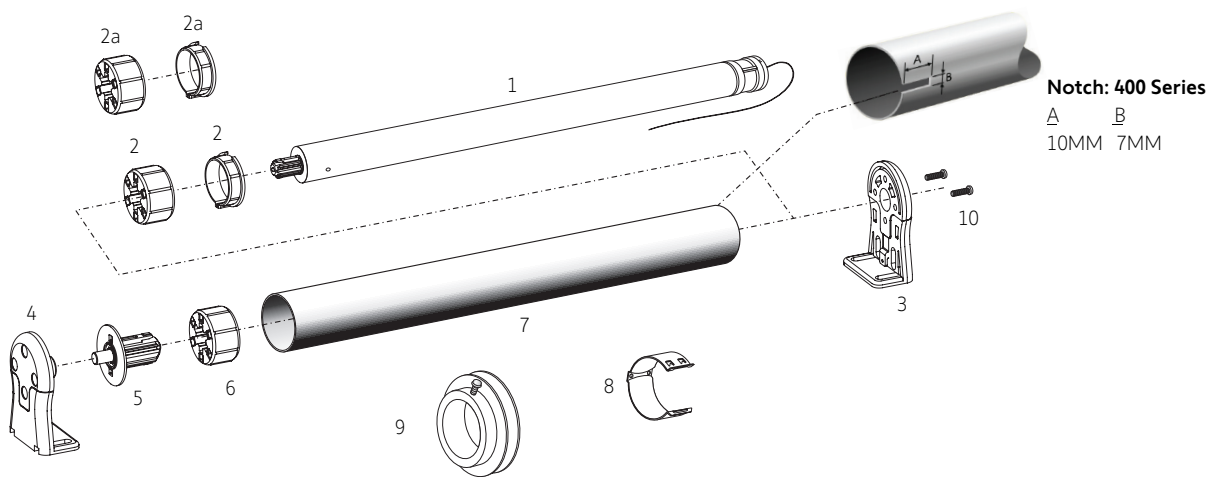

### Dimensions and Light Gap Specifications

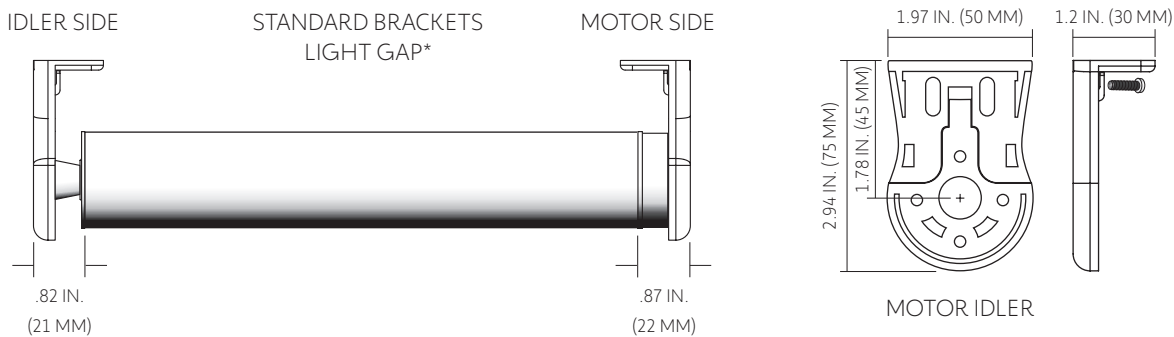

\*Dimensions for reference only and may differ depending on Mfg. product changes, installation, etc.

### Product Chart

Image	Description	Catalog Number
1	SONESSE® 40 MOTOR SHOWN	Refer to spec sheet by technology
2	CROWN AND DRIVE (SOMFY 40MM X 1.5MM ROUND TUBE)	9012224
2A	CROWN AND RUBBERIZED DRIVE (SOMFY 40MM X 1.5MM ROUND TUBE)	9016654
3	MOTOR BRACKET (DECORATOR TYPE)	9500683
4	IDLER END BRACKET (DECORATOR TYPE)	9500685
5	IDLER END PLUG (8MM DIA. PIN-DECORATOR TYPE)	9500688
6	40MM ROUND DRIVE ONLY (FOR USE WITH IDLER END PLUG)	9147544
7	SOMFY 40MM ROUND TUBE (20 FT. MAX LENGTH)	1781153
8	40MM FABRIC/CORD CLIP FOR ROMAN SHADE APPLICATIONS	9012200
9	CORD TAKE-UP REEL (40MM TUBE)	1781152
10	M3.5 X 9MM SCREWS	9014066



# 40mm Hardware Systems

## Somfy Decorator Type

### Standard Bracket Components

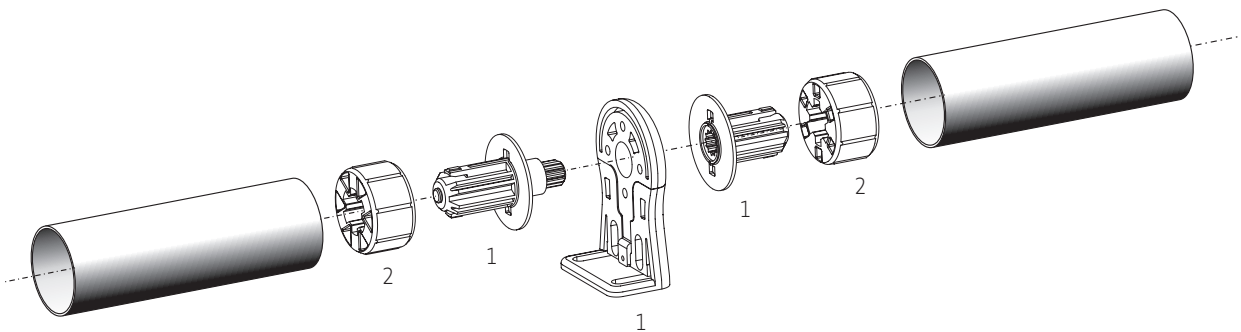

### Dimensions and Light Gap Specifications

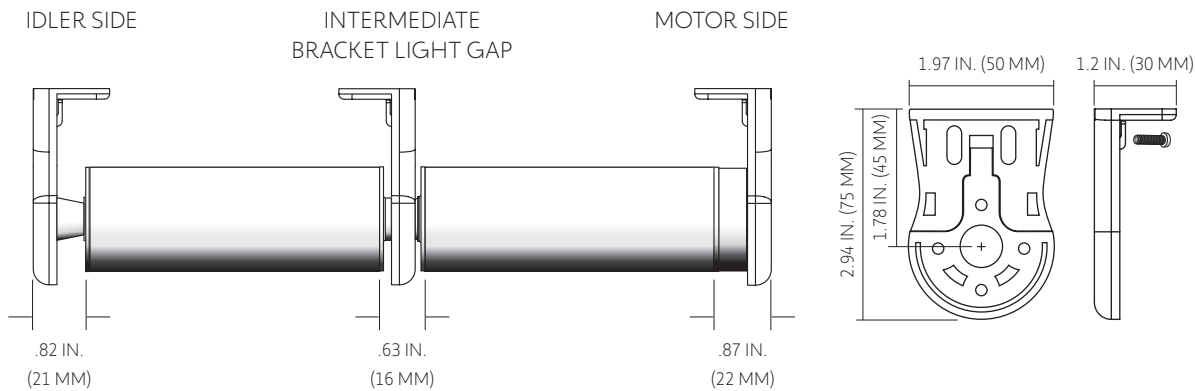

### Product Chart

Image	Description	Catalog Number
1	INTERMEDIATE BRACKET KIT (DECORATOR TYPE)	9500687
2	40MM ROUND DRIVE ONLY (FOR USE WITH INT. BRACKET)	9147544

# 40mm Hardware Systems

## RollEase® Skyline

### Standard Bracket Components

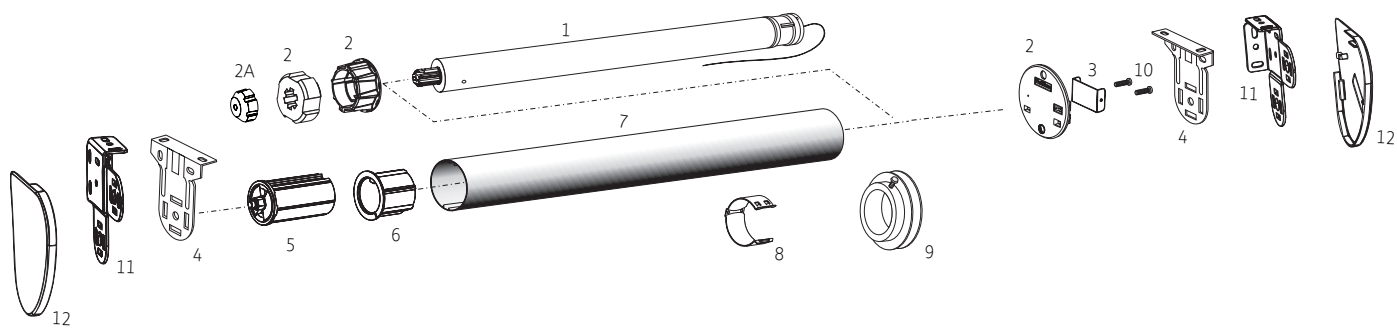

### Dimensions and Light Gap Specifications

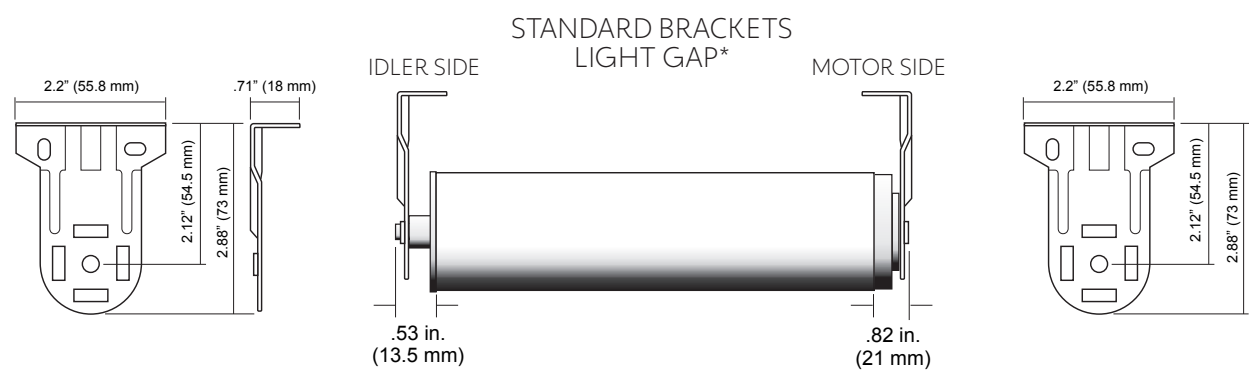

\*Dimensions for reference only and may differ depending on Mfg. product changes, installation, etc.

### Product Chart

Image	Description	Catalog Number
1	SONESSE® 40 SHOWN	Refer to spec sheet by technology
2	CROWN AND DRIVE WITH SKYLINE MOTOR MOUNT PLATE	9016352
2A	400 SERIES DRIVE STOP WITH SCREW	9147894
3	SILENT MOTOR MOUNT CLIP FOR SKYLINE BRACKET	9017255
4	ROLLEASE® SKYLINE SERIES BRACKETS 2"	9016325
5	ROLLEASE® SKYLINE SERIES IDLER END PLUG	5059165
6	IDLER ADAPTOR COLLAR 2" PROFILE TUBE	9016366
7	2" PROFILED TUBE	1781798
8	CORD CLIPS FOR ROMAN SHADE APPLICATIONS 2" TUBE	9138028
9	TAKE-UP REEL - ROLLEASE 2" TUBE	1781151
10	M3.5 X 9MM SCREWS	9014066
11	ROLLEASE® DOUBLE BRACKET	Contact Rollease
12	ROLLEASE® DOUBLE BRACKET COVERS	Contact Rollease

# 40mm Hardware Systems

Somfy CTS 40

## Cord Take-Up System (CTS)

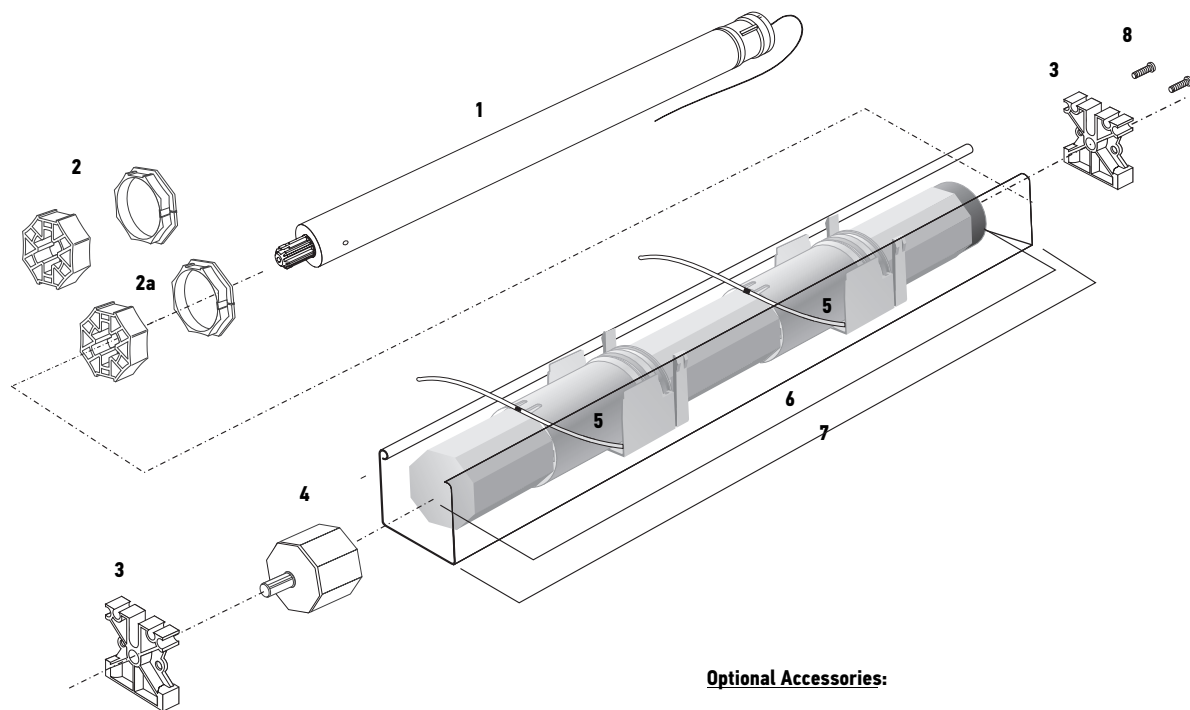

**Optional Accessories:**



1781134 - 2" Slat Clips for Wood Blinds (White)  
1781135 - 2" Slat Clips for Wood Blinds (Ivory)



1781133 - Ladder Crimp

## Product Chart

Image	Description	Catalog Number
1	SONESSE® 40 MOTOR SHOWN	Refer to spec sheet by technology
2	CROWN AND DRIVE KIT (40MM OCTAGONAL TUBE)	9012225
2A	CROWN AND RUBBERIZED DRIVE KIT (40MM OCTAGONAL TUBE)	9016655
3	MOTOR / IDLER BRACKET (FOR 57MM X 51MM HEADRAIL)	9500736
4	IDLER END PLUG FOR 40MM OCTAGONAL TUBE	9012274
5	CTS 40 (FOR 57MM X 41MM HEADRAIL)	1781118
6	SOMFY 40MM OCTAGONAL TUBE (20 FT. MAX LENGTH)	1781154
7	57MM X 51MM (2" X 2 1/4") GUTTER RAIL OR SIMILAR	Contact Manufacturer
8	M3.5 X 9MM SCREWS	9014066

# Bracket, Fascia, and Cassette Solutions

RollEase®

## Skyline™ Bracket and Fascia Accessories

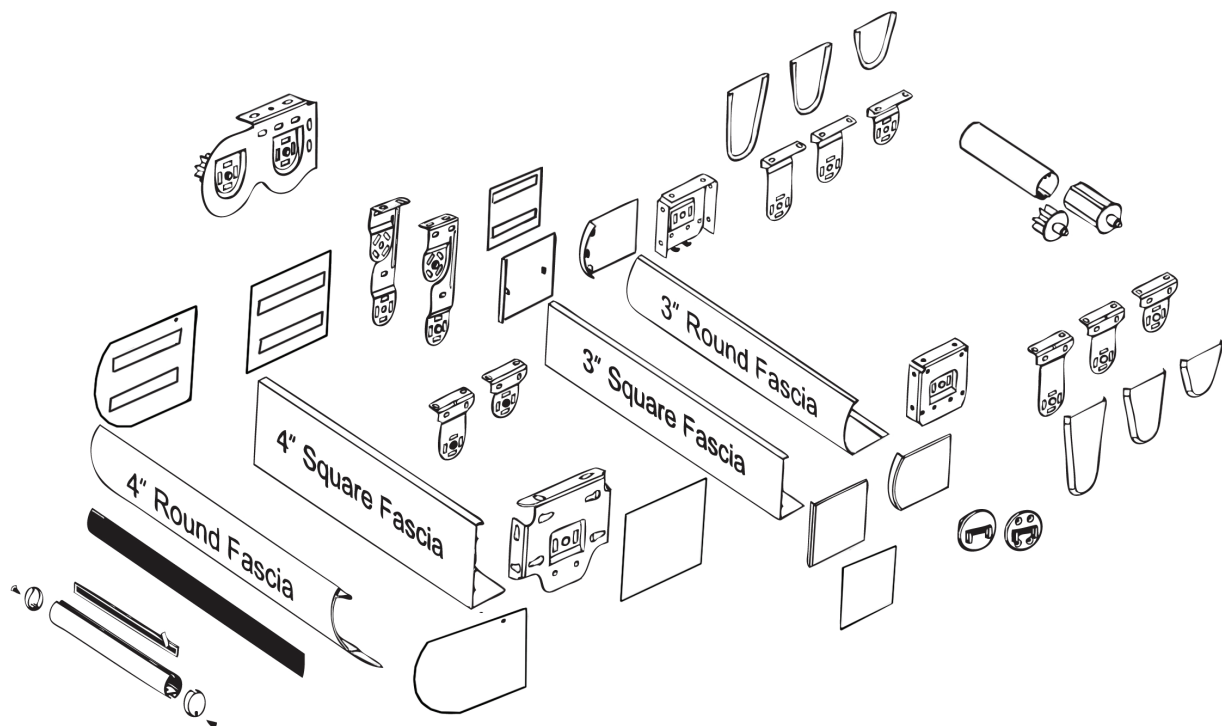

Please Note: for maximum torque limitations please refer to manufacturer's specifications

# Bracket, Fascia, and Cassette Solutions

ZMC®

## Intermediate Bracket Solutions

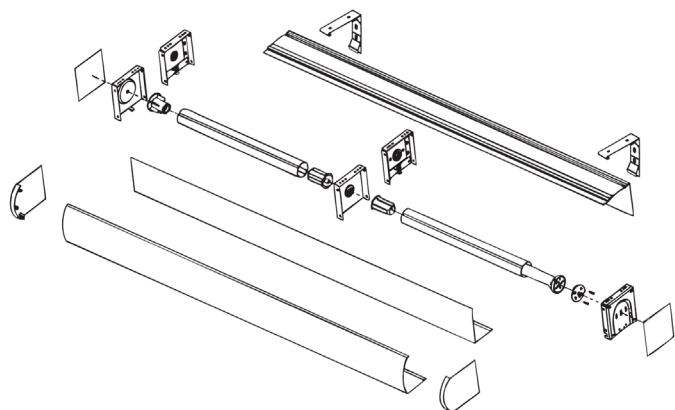

## Duo Shade Fascia Components

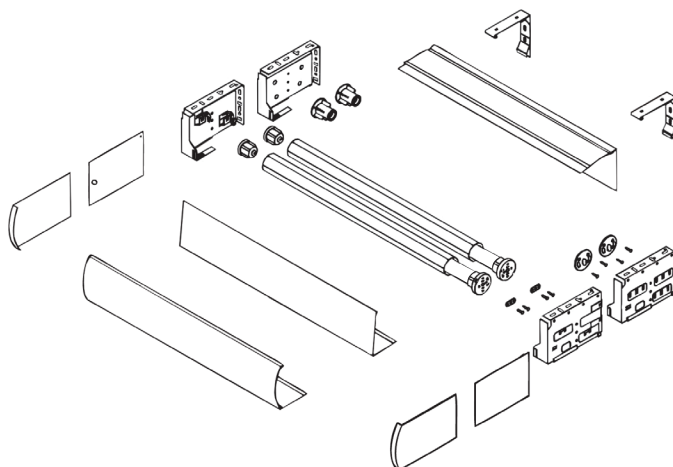

# 40mm Mechanical Accessories

## Brackets & Kits

### 400 Series to 500 Series Adaptor Kit



- Allows the use of 500 Series crowns and drives with 400 Series motors
  - Black composite
  - Maximum motor torque - 13 Nm
- Part #9013763

### 400 Series "LO" Bracket w/ a Square Stud



- Motor mounting screws included
  - 10mm square stud
  - Zinc plated steel
  - Maximum motor torque 13 Nm
- Part # 9147334

### 400 Series Drive Stop w/ Screw



- Prevents drive disengagement from 400 series motor shaft
  - 1 screw included
- Part #9147894

### 400 Series Motor Bracket



- Compatible with RollEase Bracket
  - Stainless steel
  - Maximum motor torque - 4 Nm
- Part #9012258\*
- \*to be used with M3.5x8MM screw*

### 400 Series to 500 Series Mounting Conversion Bracket



- Composite
  - Allows 400 Series motors to be used w/ 500 Series Star Head motor brackets
  - Maximum motor torque - 9 Nm
  - 2 screws included
- White: #9027508 (works with new interior head motors with recessed plates)
- Black: #9500659 (works with legacy motors old head)

## Sonesse® Motor Plates & Head Covers

Item #	Description	Photo	Compatible with
9025996	RollEase 360 R3-R8 10mm x 1.8mm Pin Diameter 6.8mm and Screws		AC Zigbee PoE AC RS485
9026001	Rollease 360 R3-R8 10mm x 1.8mm Pin Diameter 7mm and Screws		AC Zigbee PoE AC RS485
9025999	Acmeda 12mm and Screws		AC Zigbee PoE AC RS485
9026003	RollEase SkyLine and Screws		AC Zigbee PoE AC RS485
9026093	M3 x 6mm Philips Flat-Head Plastite (Screw)		AC Zigbee PoE AC RS485
9025997	Rollease 580 R16-24 15.9mm x 1.8mm & Screws		AC Zigbee PoE AC RS485
9026000	Rollease RBGAL 16x3.2mm & Screws		AC Zigbee PoE AC RS485
9027132 9027133 9027134	Motor Head Cover, White (Supplied with Motor) Motor Head Cover, Grey Motor Head Cover, Black		PoE
9026090 9026091 9026092	Motor Head Cover, White (Supplied with Motor) Motor Head Cover, Grey Motor Head Cover, Black		RS485

# 40mm Mechanical Accessories

## Crowns and Drives

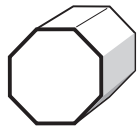

ø 1.5 in. / 40mm Octagonal



400 Series Crown  
for 40 x 0.8mm Octagonal Tube  
Part #9147327



400 Series Drive  
for 40 x 0.8mm Octagonal Tube  
Part #9147545

400 Series 40mm Octagonal Set  
Part #9012225



NEW 400 Series Crown and Rubberized  
Drive for 40mm Octagonal Tube  
Part #9016655\*

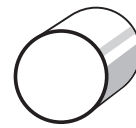

ø 1.5 in. / 40mm Round



400 Series Crown  
for 40 x 1.5mm Round Tube  
Part #9147330



400 Series Drive  
for 40 x 1.5mm Round Tube  
Part #9147544

400 Series 40mm Round Set  
Part #9012224



NEW 400 Series Crown and Rubberized  
Drive for 40mm x 1.5mm Round Tube  
Part #9016654\*

### 400 Series to 500 Series Adaptor Kit

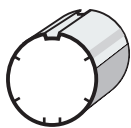

ø 44mm Acmeda



Crown Adaptor 44mm  
Tube (Acmeda Type)  
Part #9013791



Soft Drive Wheel 44mm  
(Acmeda Type)  
Part #9013790

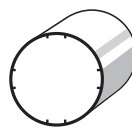

Rollease/ZMC 2" Profiled Tube



Crown & Drive for Rollease/ZMC  
2" Profiled Tube  
Part #9016352\*

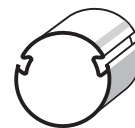

ø 50mm Hunter Douglas



400 Series Crown and Drive for  
HD 4" Silhouette\* (Quartette™)  
Part #9016953\*

\*Due to material composition it is recommended to apply a silicon-based lubricant to drive adaptor surface prior to motorized roller tube assembly. 400 Series drive stop with screw (part #9147894) should also be used to prevent drive disengagement during installation or removal.



Make the move

#### About Somfy®

For over 50 years, Somfy has been pioneering innovative motorization and automated solutions for window coverings and exterior shading products. With comfort, ease of use, security, and sustainability in mind, our seamless and connected solutions are designed to help people make the move to living spaces impactful for humans and with a reduced impact on nature.

A BRAND OF **SOMFY** GROUP

New Jersey  
121 Herrod Blvd.  
Dayton, NJ 08810  
T: (609) 395-1300  
F: (609) 395-1776

Somfy Systems, Inc.  
T: (800) 22-SOMFY  
[www.somfypro.com](http://www.somfypro.com)  
  
Florida  
1200 SW 35th Ave.  
Boynton Beach, FL 33426  
T: (561) 995-0335  
F: (561) 995-7502

California  
15301 Barranca Pkwy.  
Irvine, CA 92618-2201  
T: (949) 727-3510  
F: (949) 727-3775

Somfy ULC  
T: (800) 66-SOMFY  
[www.somfypro.ca](http://www.somfypro.ca)  
  
Canada  
6411 Edwards Blvd.  
Mississauga, ON L5T 2P7  
T: (905) 564-6446  
F: (905) 238-1491

© Somfy Systems, Inc. • **DECEMBER 2025**  
Acmeda® is a registered trademark of Acmeda International Group Incorporated  
RollEase® is a registered trademark of RollEase® Inc. - Stamford, CT.  
Creston® is a registered trademark of Creston Electronics, Inc.  
ZMC® is a registered trademark of ZMC® Window Coverings  
Universal Remote Control, Inc. is a trademark of Universal Remote Control, Inc.  
Zigbee® is a registered trademark of Connectivity Standards Alliance.  
Amazon, Alexa, and all related logos are the trademarks of Amazon.com, Inc. or its affiliates.  
All brands, products, and trademarks are the property of their respective owners.  
Photos : © Somfy Activités SA, Sémaphore.