

# Sonessse® 30 RTS

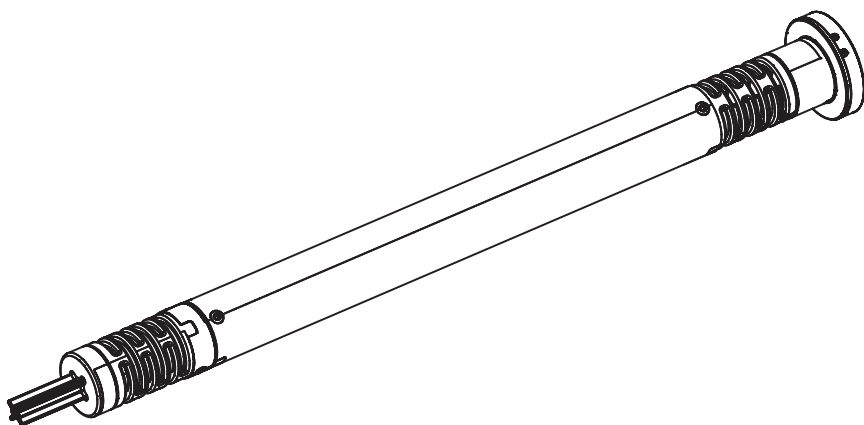

## SAFETY

- This Somfy product must be installed by a professional motorisation and home automation installer, for whom these instructions are intended.
- Before installation, check that this product is compatible with the associated equipments and accessories.
- These instructions describe how to install, commission and use this product.
- Moreover, the installer must comply with current standards and legislation in the country in which the product is being installed, and inform his customers of the operating and maintenance conditions for the product.
- Any use outside the sphere of application specified by Somfy is not approved. Such use, or any failure to comply with the instructions given herein will invalidate the warranty, and Somfy refuses to accept liability.

## COMPATIBLE BLINDS

Roller blinds

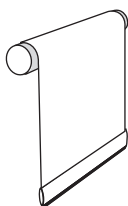

Venetian blinds

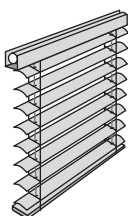

Roman shades



## GENERAL SAFETY INSTRUCTION

The safety instructions that must be observed, besides the usual rules, are explained in these instructions and in the attached «Safety Instructions» document.

Never immerse the motor in liquid!



Avoid impacts!

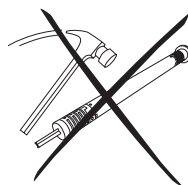

Never drill holes in the motor!

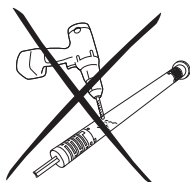

Do not drop it!

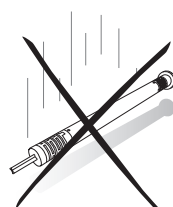

## INSTALLATION

### Motor preparation

1) Fit the crown (a) and drive wheel (b) to the motor.

2) Measure the length (L) between the middle of the drive wheel and the head end.

### Tube preparation

Cut the tube to the required length. Deburr the tube and remove the debris.

### Motor/tube assembly

1) Slide the motor into the tube.

2) Fix the tube to the motor with self-tapping screws or steel pop rivets depending on the dimension (L).

### Mounting the motorized tube on the brackets

If necessary, screw the bracket interface on the motor head.

1) Mount the motorized tube on the end bracket (c).

2) Mount the motorized tube on the motor bracket (d).

### Wiring

Connect the power cable to the motor.

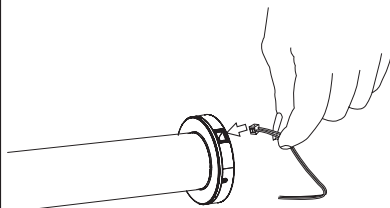
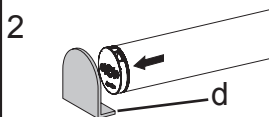
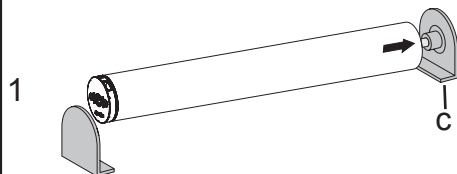
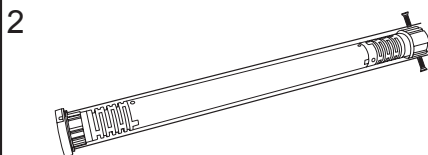
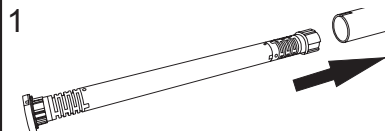
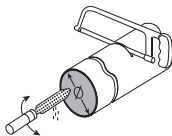
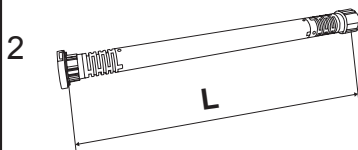
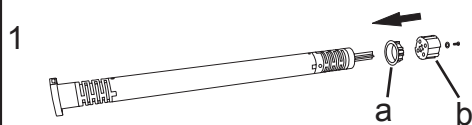

## COMMISSIONING

### Programming the RTS control point

Switch on the power supply.  
Press the UP and DOWN buttons simultaneously on the RTS control point: the shade moves for a few seconds and the control point is preprogrammed in the motor

### Checking the direction of rotation

Press the RTS control point UP button:  
a) If the shade is raised, the direction of rotation is correct: move to the section entitled «Adjusting the end limits».  
b) If the shade is lowered, the direction of rotation is incorrect: move to the next step.

Press the RTS control point MY button until the shade jogs: the direction of rotation has been modified.

Press the RTS control point UP button to check the direction of rotation.

### Adjusting the end limits

The limits can be set in any sequence.

- 1) Press and hold the UP button to move the shade to the desired up position.
- 2) Press the MY and DOWN buttons simultaneously and release them once the shade begins to move. The up limit is memorized.
- 3) Press the MY button when it reaches the desired down position. If necessary adjust the down position, using the UP or DOWN buttons.
- 4) Press the MY and UP buttons simultaneously and release them when the shade begins to move. The down limit is memorized. The shade moves up and will stop at its upper limit.
- 5) To confirm the end limits press and hold the MY button until the shade jogs. The end limits are recorded.

### Recording the RTS control point

Press the programming button on the back of the RTS control point until the motor jogs. The RTS control point address is permanently recorded.

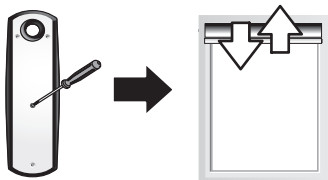
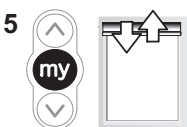
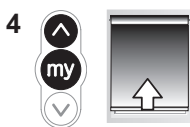
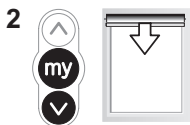
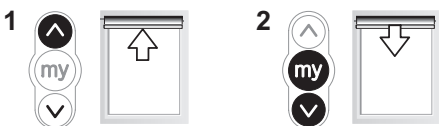
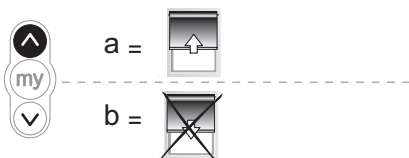
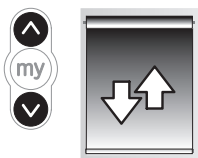

## USE

### Mode Selection: Roller or Tilting mode

By factory default, the motor is in Roller mode but you can change from one mode to another.

Move the shade away from the end limits.

1) Press the UP and DOWN buttons until the shade jogs.

2) Press and hold the MY and DOWN buttons simultaneously until the shade jogs to change from Roller mode to Tilting mode.

### MY position

#### 1) Recording MY position.

To set the MY position, move the shade to the desired position with the UP and DOWN buttons then press the MY button until the shade jogs.

#### 2) Changing the MY position

To change the MY position go to the new desired MY position with the UP and DOWN buttons then press the MY button until the shade jogs.

#### 3) Delete the MY position

To delete the MY position, move to this position and press the MY button until the shade jogs.

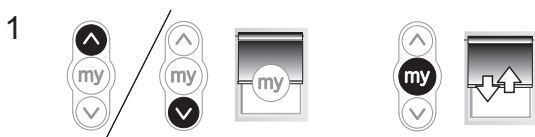

## Sun disappearing position

This function is available only if a MY position is recorded.

### 1) Recording Sun disappearing position.

Press and hold the MY and DOWN buttons simultaneously until the shade jogs.

Move the shade to the desired position with the UP and DOWN buttons.

Press and hold the MY button until the shade jogs.

The sun disappearing position is recorded.

### 2) Changing the Sun disappearing position.

Press the MY and DOWN buttons simultaneously. The shade moves to the Sun disappearing position.

Move the shade to the new desired position with the UP and DOWN buttons.

Press and hold the MY button until the shade jogs.

The sun disappearing position is changed.

### 3) Delete the Sun disappearing position.

Press the MY and DOWN buttons simultaneously. The shade moves to the Sun disappearing position.

Press and hold the MY button until the shade jogs.

The sun disappearing position is deleted.

1

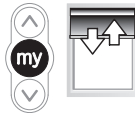

2

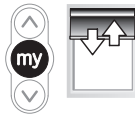

3

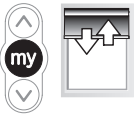

## UP, DOWN and MY

### In roller mode

1) To move the shade from a limit to the other limit, press briefly the UP or DOWN button.

2) To stop the shade, press the MY button.

3) To move the shade to the MY position, press briefly the MY button.

### In tilting mode

1) To move the shade from a limit to the other limit, press briefly (less than 0,5s) the UP or DOWN button.

2) To stop the shade, press the MY button.

3) To move the shade to the MY position, press briefly the MY button. The Venetian blind goes first to the down end-limit, then to the MY position.

4) To tilt the slats, press and hold the UP or DOWN button or use the scroll of the remote control until the slats reach the desired position.

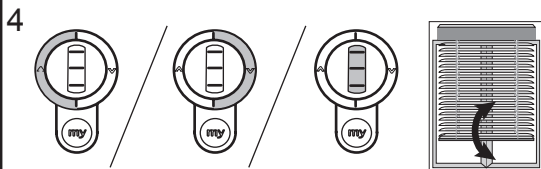
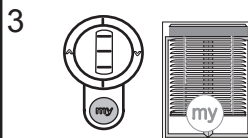
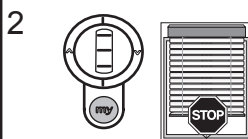
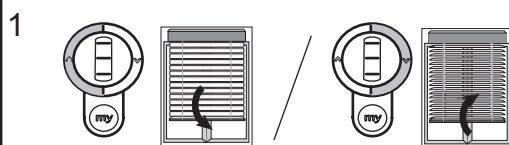
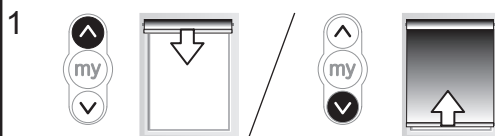

## Adding/Deleting RTS control points

Find an RTS control point programmed in the motor.

Press and hold the RTS programmed control point (A) PROG button or the motor PROG button until the shade jogs: the motor is in programming mode.

Quickly press the RTS control point (B) PROG button to add or delete: the shade jogs and the RTS control point is programmed or deleted from the motor.

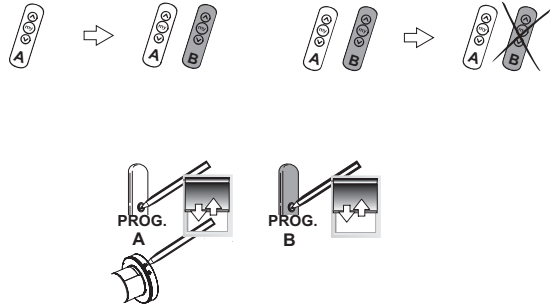

## Adding/Deleting RTS sensors

Find an RTS control point programmed in the motor.

Press and hold the RTS programmed control point (A) PROG button or the motor PROG button until the shade jogs: the motor is in programming mode.

Quickly press the RTS sensor (C) PROG button to add or delete: the shade jogs and the RTS sensor is programmed or deleted from the motor.

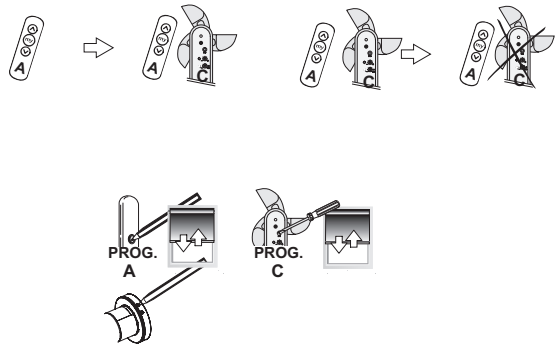



## Sun function

For this function, you need a Telis Soliris transmitter.

By default, the Sun function is not active.

1) To activate the Sun function, press the SELECT button on the Telis Soliris transmitter until the shade jogs.

2) To disactivate the Sun function, press the SELECT button on the Telis Soliris transmitter until the shade jogs.

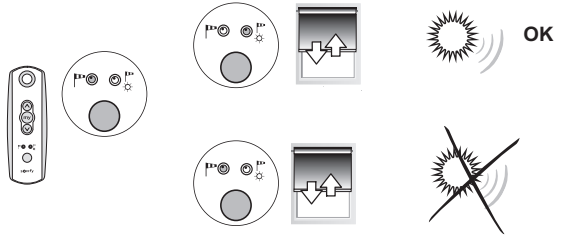

When the intensity of the daylight exceeds the threshold set by the soliris sensor RTS, a DOWN order is sent to the shade after 2 min.

The shade goes to the MY position or to its down limit if no MY position has been memorised.



When the intensity of the daylight falls below the threshold set by the SOLIRIS sensor RTS, the shade goes to the sun disappearing position or stays at its position (MY or down limit) if no sun disappearing position has been memorised.



The Wind function is not compatible with this motor.

### Adjusting the roller speed

1) Press the UP, MY and DOWN buttons simultaneously until the shade jogs once. The shade moves up and down automatically in 10 second cycles.

2) While the shade is moving, briefly press the UP button to increase the speed or DOWN button to decrease the speed.

3) To confirm the new speed, press and hold the MY button until the shade jogs.

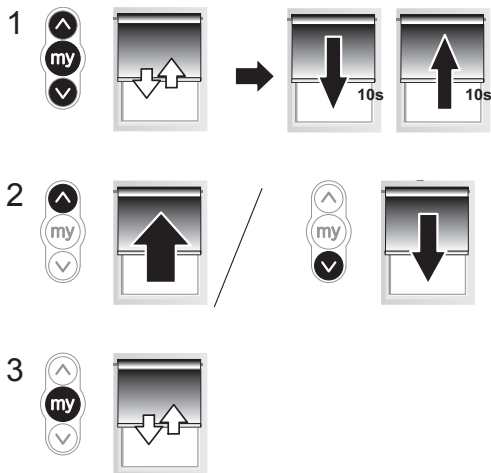

### Adjusting the tilting speed

1) Press the UP, MY and DOWN buttons simultaneously until the shade jogs twice. The shade moves up and down automatically in 10 second cycles.

2) While the shade is moving, briefly press the UP button to increase the speed or DOWN button to decrease the speed.

3) To confirm the new speed, press and hold the MY button until the shade jogs.

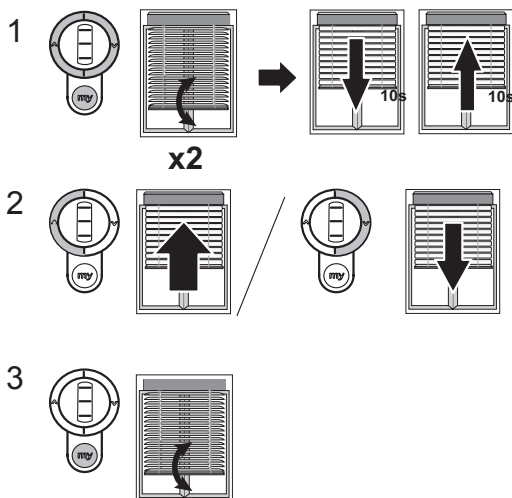

## End limit re-adjustment

### UP LIMIT

- 1) Press the UP button, to move the shade to the limit to be readjusted.
- 2) Press and hold the UP and DOWN buttons simultaneously until the shade jogs.
- 3) Press and hold the UP or DOWN button to move the shade to the new desired position.
- 4) To confirm the new limit press and hold the MY button until the shade jogs.

### DOWN LIMIT

- 1) Press the DOWN button to move the shade to the limit to be readjusted.
- 2) Press and hold the UP and DOWN buttons simultaneously until the shade jogs.
- 3) Press and hold the UP or DOWN button to move the shade to the new desired position.
- 4) To confirm the new limit press and hold the MY button until the shade jogs.

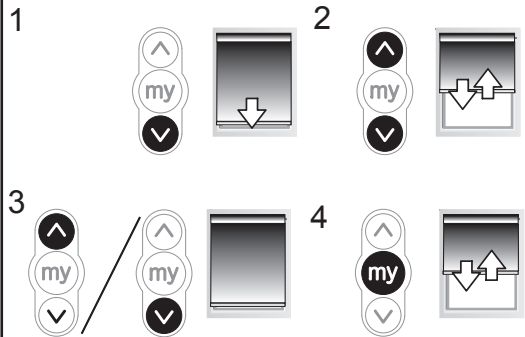
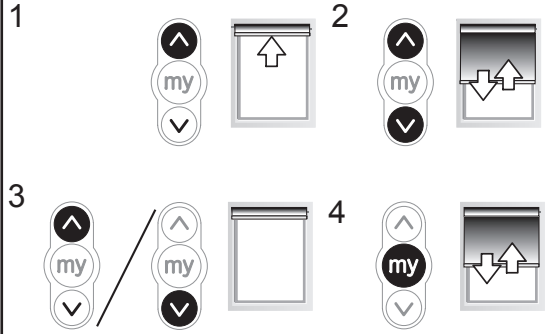

### Modifying the motor rotation direction

Move the shade away from the end limits.

1) Press the UP and DOWN buttons simultaneously until the shade jogs.

2) Press the MY button until the shade jogs to reverse the rotation direction.

3) Press the UP button to check the new direction of rotation.

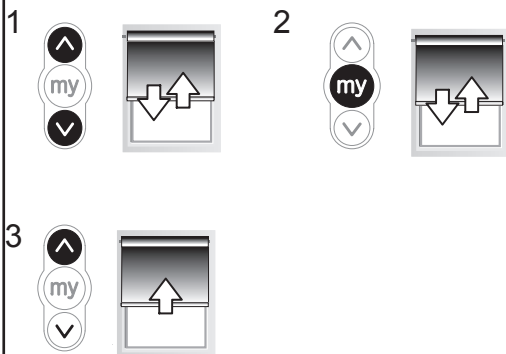

### Modifying the wheel rotation direction

Move the shade away from the end limits.

1) Press the UP and DOWN buttons simultaneously until the shade jogs.

2) Press the UP, MY and DOWN buttons simultaneously until the shade jogs to reverse the wheel rotation direction.

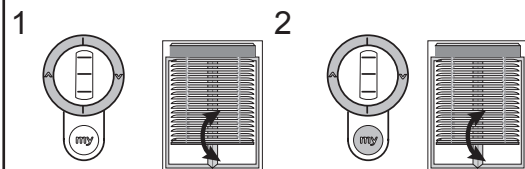

### Erasing the transmitters of the motor

To delete all the transmitters programmed, press and hold the motor prog button until the shade jogs twice. All the transmitters are deleted.

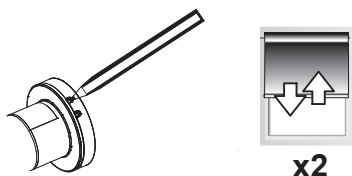

### Erasing the sensor of the motor.

To delete all the sensors programmed, press and hold the RTS programmed control point (A) PROG button or the motor PROG button until the shade jogs.

Quickly press and hold the RTS sensor (C) PROG button until the shade jogs twice.

All the sensors are deleted.

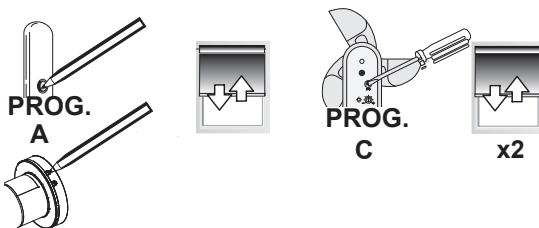

### Erasing the memory of the motor

To reset the motor, press the prog button on the motor head until the shade jogs 3 times.

All the settings are erased.

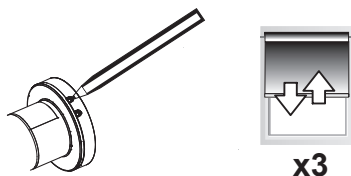

## Technical data

<b>Voltage</b>	<b>24V</b>
<b>Frequency</b>	<b>433MHz</b>
<b>Operating temperature</b>	<b>0°C / 60 °C</b>
<b>Protection rating</b>	<b>IP30</b>
<b>Torque</b>	<b>2 Nm</b>
<b>Adjustable Speed</b>	<b>6 → 28 rpm</b>
<b>Roller Speed (By default)</b>	<b>28 rpm</b>
<b>Tilting Speed (By default)</b>	<b>16 rpm</b>

## Troubleshooting

### The motor doesn't work:

#### Verify:

- The wiring of the motor.
- The power supply specifications.
- The compatibility of the control
- The heat generated (wait 5 minutes for the cooling of the motor).

### The equipment stops too soon:

#### Verify:

- The operation of end-limits during the rotation of the motor.
- The crown is properly fitted to the tube.
- The end-limits of the motor are properly adjusted.
- Verify that the shade is within the recommended weight limit.